

**SURVEYOR'S RECORD
BOOK**

**Montgomery County
Indiana**

No 3

T19N – R3W

FRANKLIN

Section 1. Township 19 North, Range 3 West.

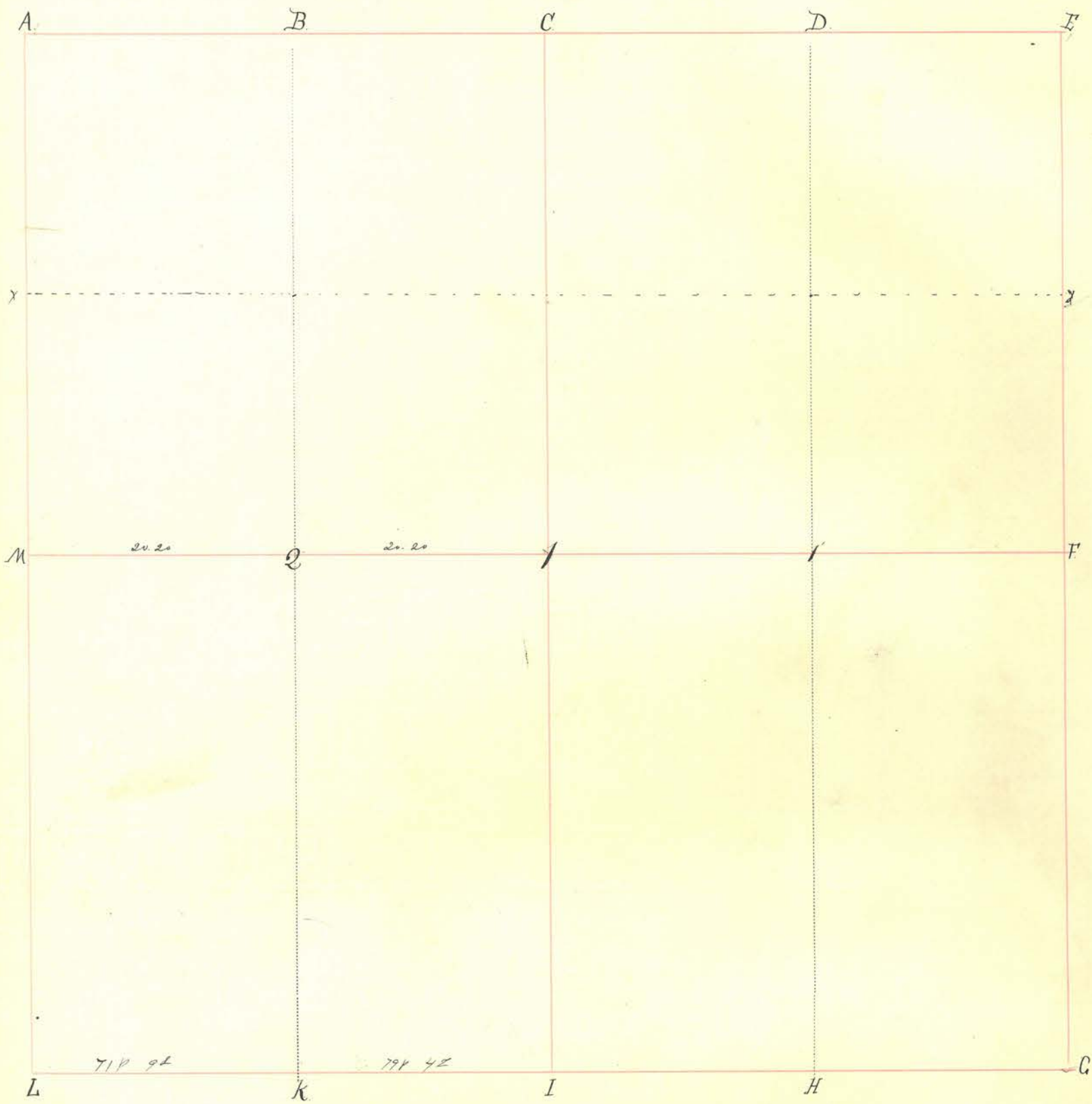

INDEX.	CORNERS.	SIZE.	MARKS.	WITNESSES.	SIZE.	DIRECTION.	DISTANCE.	MARKS.
A.								
B.								
C.	Stone.							
D.								
E.								
F.								
G.								
H.								
I.								
K.	Stone.			Beech	23"	N. 39 1/2° E.	21.	
L.	Stone, Original Corner.			" "	20"	S. 23 1/2° E.	9.	
M.	Stone.			White Ash.	10"	South	4.	
N.	Stone							
1'	Stone.			Gray Oak.	13"	N 61 1/2° E	21.	
2.	Stone.			Hickory.	16"	S 41 1/2° W	38.	

INDEX.	CORNERS.	SIZE.	MARKS.	WITNESSES.	SIZE.	DIRECTION.	DISTANCE.	MARKS.
X				Red Oaks	10"	N. 57° W	12.	
				" "	3"	S. 89° E	17.	
Y	Stone			Red Oaks	4"	S. 12½° E.	28.	
				Stk.	8.	N. 75½° W.	30.	

June 8th 1858.

W³ of S. W. gr for Jacob Borchers. E³ for Borka

Richard C.S

Section 2, Township 19 North, Range 3 West.

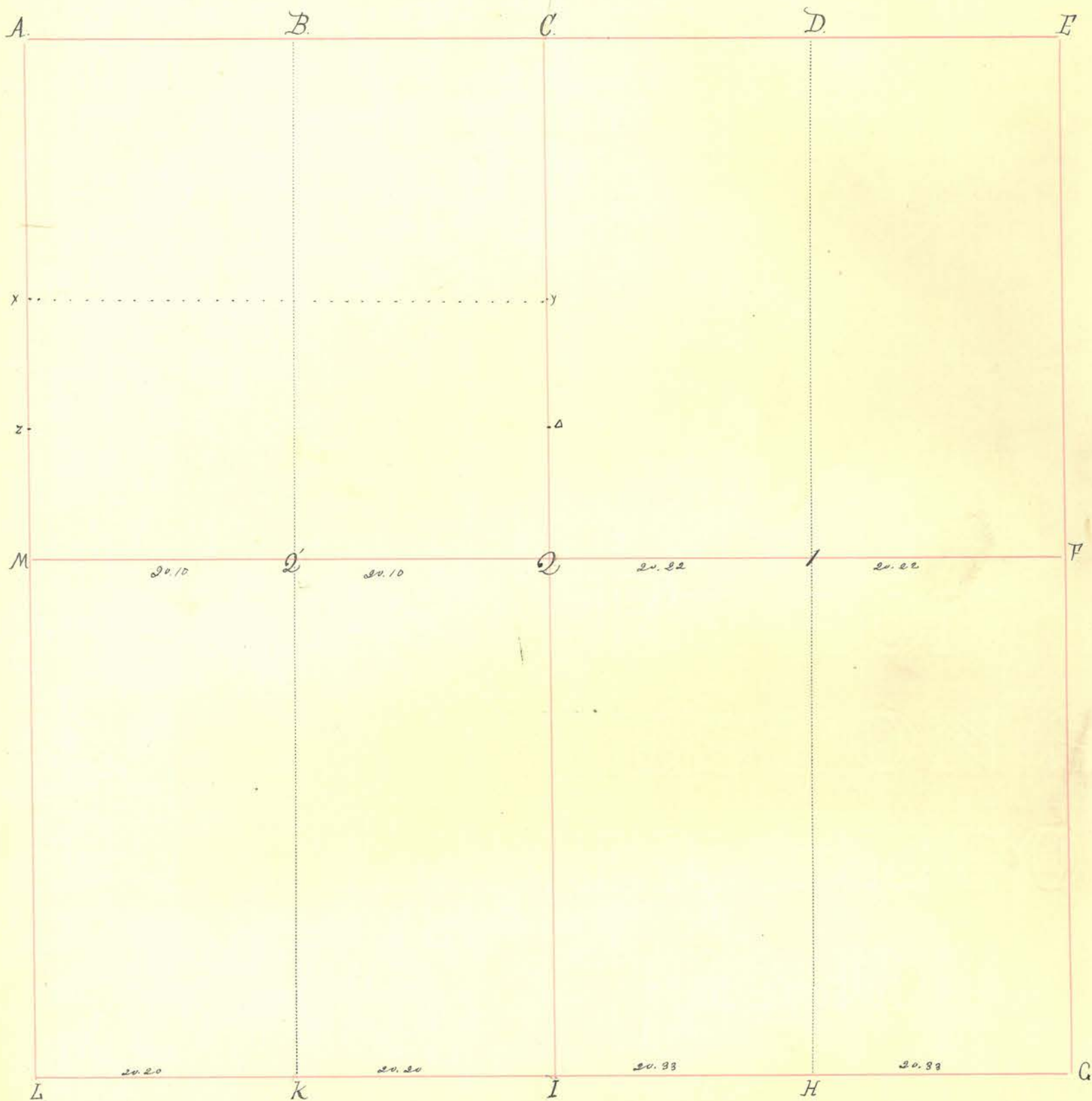

INDEX.	CORNERS.	SIZE.	MARKS.	WITNESSES.	SIZE.	DIRECTION.	DISTANCE.	MARKS.
A.								
B.								
C.								
D.								
E.								
F.								
G.								
H.								
I.	Stone							
K.	Stone							
L.								
M.								
Q.	Stone			Asch. Hickory White Oak. fella post Red Oak Hickory Buck Hickory	13" 9" 5" 36" 18" 18"	N 22° W 8 1/2' W S 49° E N 19° W S 42° E N 43° W	to 6 1/2' Ch. to 3 1/2' "	
I.								
Q.	Stone							

(Back)

Section 9

Township 19

North, Range 3

West.

INDEX.	CORNERS.	SIZE.	MARKS.	WITNESSES.	SIZE.	DIRECTION.	DISTANCE.	MARKS.
x	Stone.							
y	Stone.							
z	Stone							
A				Apple " "	4" 4"	S. 44° E N. 79° E	73 60.	

Section 4, Township 19 North, Range 3 West.

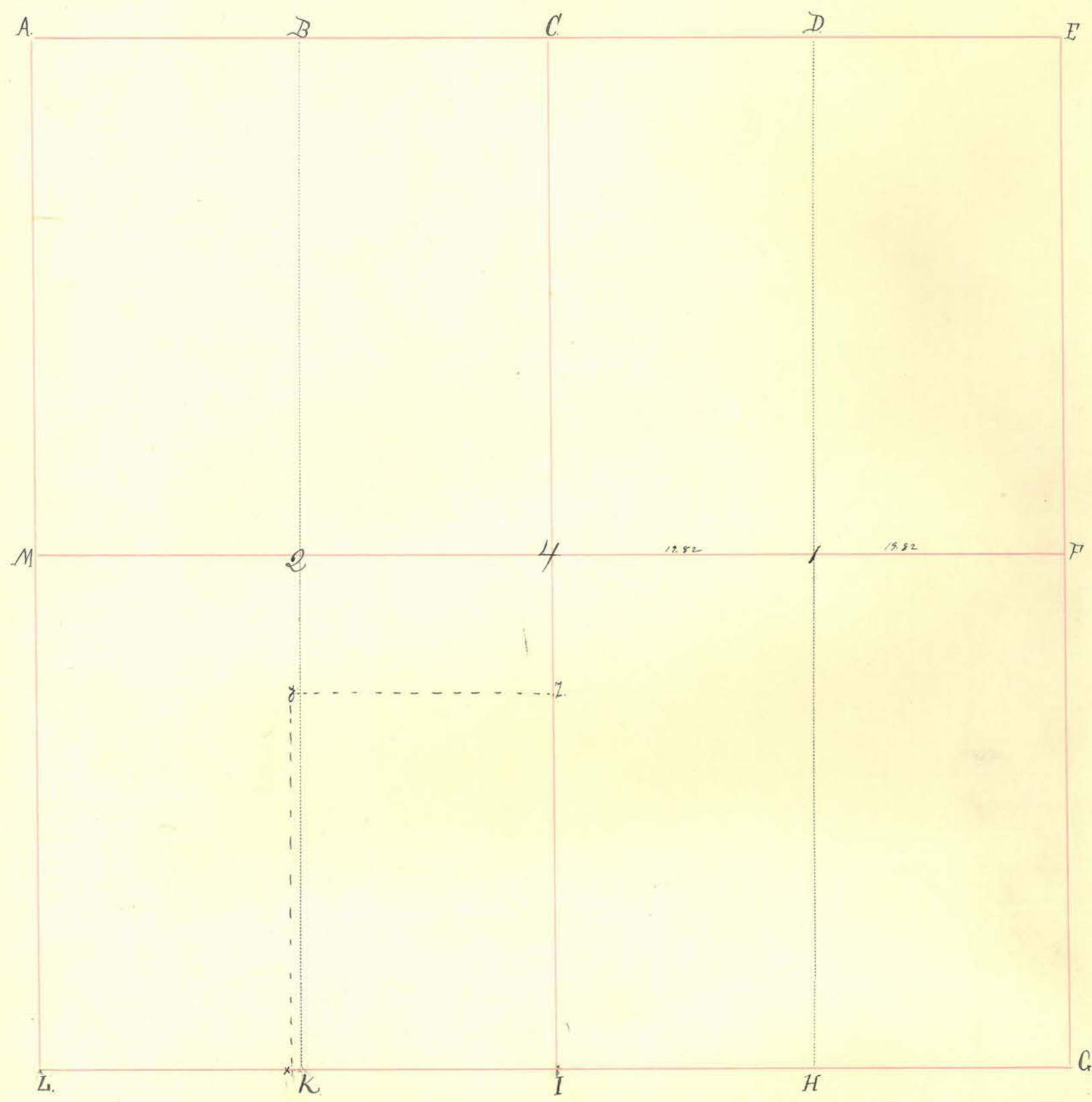

INDEX.	CORNERS.	SIZE.	MARKS.	WITNESSES.	SIZE.	DIRECTION.	DISTANCE.	MARKS.
A.								
B.								
C.				Cherry Stub Oak	8" 20"	N. 14° W. S. 68° E.	7 20.8	
D.								
E.								
F.	STONE			(SEE 1904 SURVEY WITNESSES)				
G.								
H.	Stone			Cherry Buck	26" 18"	S. 73° W. N. 62° E.	7 33.	
I.	Stone							
K.								
L.								
M.	Stone.							
4.	STONE	(SEE 1904 SURVEY WITNESSES)		White Oak Hickory. STONE	4" 16" 12" x 12"	S. 1° W. N. 36° W. EAST	34 20. 19.935	+ +
1.	IRON PIN	1/4 x 1/4	STONE STONE	STONE Ironwood	12" x 12" 14" 14"	WEST N. 77° E	19.975 5.	+ +
2.								
x.	Stone		x	Nelson Tombstone half quarter stone I		S. 62° W. S. 23 1/2° W	23. 28 1/2	
J.	Stone			ash.	9"	E. S. 35° W	34. 28 1/2	
Z.	Stone.			"	10"	N. 55° W	14 1/2	

INDEX. CORNERS. SIZE. MARKS. WITNESSES. SIZE. DIRECTION. DISTANCE. MARKS.

June 10th 1881.
 N¹/₂ of N.E. qr. and E¹/₂ of S.E. qr. for James Bernathy. S¹/₂ of N.E. qr.
 for Osa Holand. Plats filed.
 Ketchum.

June 8th 1868.
 Surveyed by giving the Parties written notice,
 File "Old Record".

State of Indiana }
 Montgomery County } ss -

Surveyed a line 82 rods west of the half section line as follows: began at I and ran west 82 rods. (found K. 20.16 claims) to x. set a stone, ran north to y 119 rods. found stone at Z. ran west to y. 82 rods. set stone. Surveyed for Samuel Paddock and Isaac Cox. Parties present and consenting (Cox claiming the strip between this line and the half-quarter line). Chaimmen Samuel Paddock + myself.

August 18, 1900:

Chase Harding, Dep. S. M. Co.
 12" x 12" East 19.935
 12" x 12" West 19.735

1 June pin 1 1/4 x 1 1/4 stone
 Dic. 14 1904, Established line bet. 2 & 4 w-32 4-19-3, as above, both parties, namely John Cox and Cox being present and aiding. Found dist. June F to 4 to be 39.87 & placed pin at 1, halfway bet. F and 4. 41.54 num. Dep. S. M. Co. Ind.

Section 5 Township 19 North, Range 3 West.

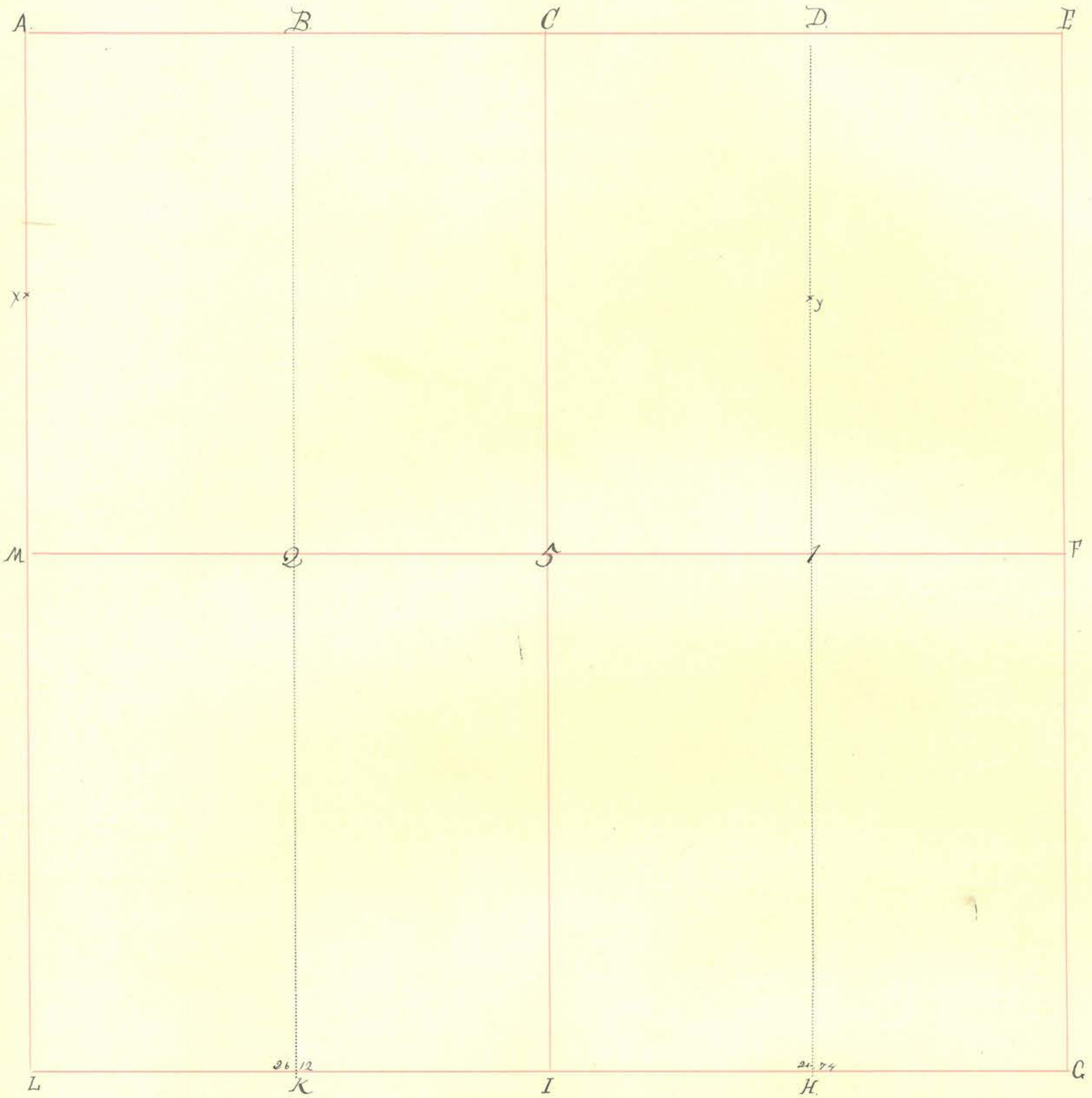

INDEX.	CORNERS.	SIZE.	MARKS.	WITNESSES.	SIZE.	DIRECTION.	DISTANCE.	MARKS.
A.				Elm.	20"	S. 34 1/2° E	23 1/2 ft.	
B.				Hickory	22"	S. 84° E	46 ft.	
C.				S. Oak.		S. 64 1/2° W.	27 ft.	
D.								
E.				White Oak.	24"	S. 11° E	13 ft.	
F.								
G.				White Oak	12"	South-	230 ft.	
H.				" " "	14"	S. 89° E.	264 ft.	
I.	Stone.			Red Oak	24"	S. 60° W.	21 1/2 ft.	
K.								
L.				Iron nail Stump. Stone found.		S. 37° W.	15 ft.	
M.	Stone							
5.	Stone	2' x 3" x 6"	+	Original Buckeye Sugar Hickory	18" 13" 12"	N. 60° E.	26 1/2 ft.	
1.								
2.	Stone							

Section 5 Township 19 North, Range 8 West.

INDEX.	CORNERS.	SIZE.	MARKS.	WITNESSES.	SIZE.	DIRECTION.	DISTANCE.	MARKS.
x	Stone							
y	Stone						Vide "Old Record"	

Section

Township

North, Range

West.

INDEX. CORNERS. SIZE. MARKS. WITNESSES. SIZE. DIRECTION. DISTANCE. MARKS.

April 27 1902

All parties present and consenting I established corners at a, b, c, d
James A. Harding
S. M. Co

a	Stone	4" x 6" on top	
b	"	pointed - 2'-long	
c	"	"	+
d	"	"	+
e	"	3" x 7' on top	

Section 7 Township 19 North, Range 3 West.

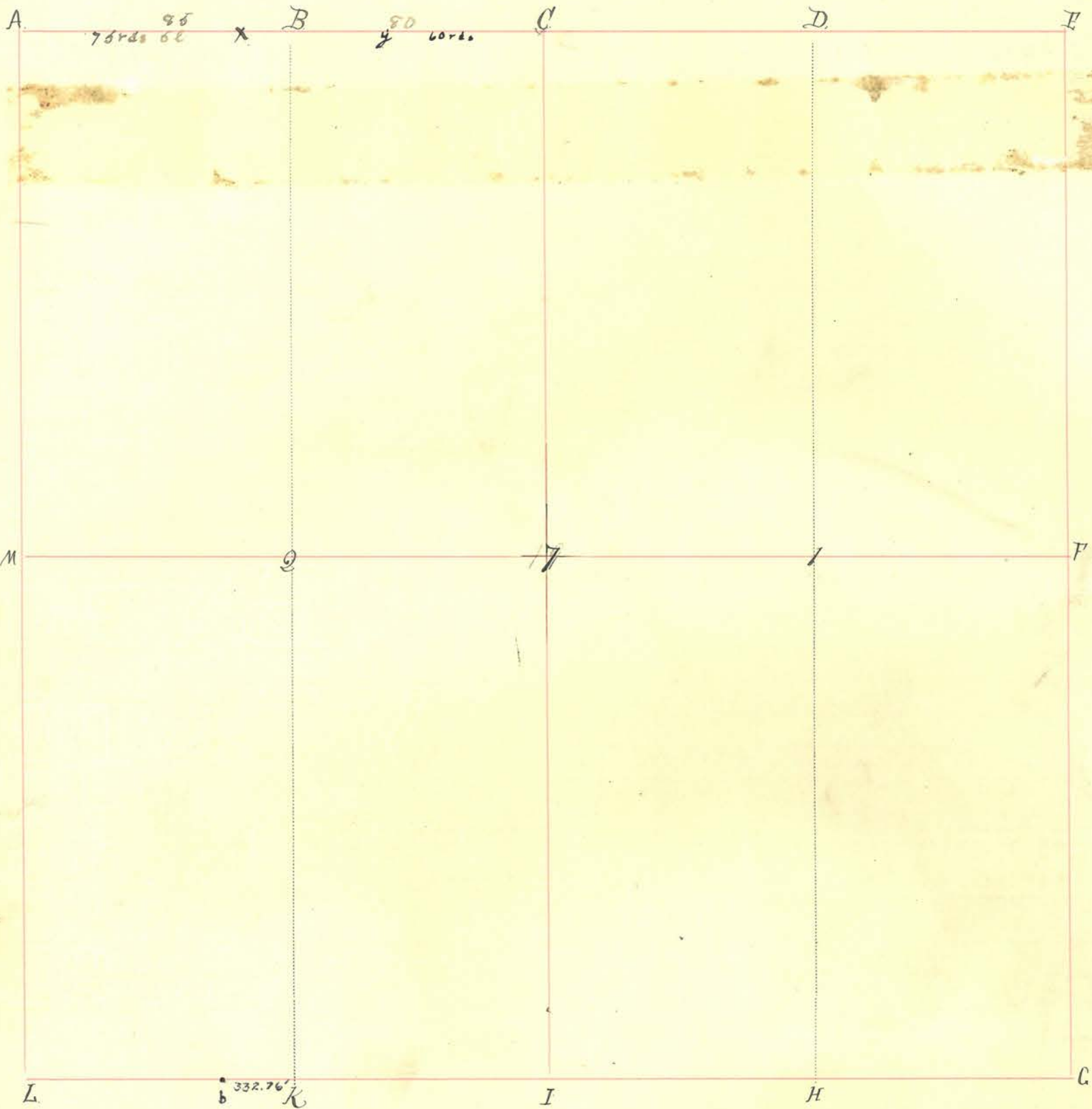

INDEX.	CORNERS.	SIZE.	MARKS.	WITNESSES.	SIZE.	DIRECTION.	DISTANCE.	MARKS.
A.								
B.	Stone							
C.	Stone	12x8+6	Pointed	Telephone pole	6"	N45E	35 1/2	
D.	Stone			Edm. Lynn. Oak W O	18" 24" 20 24	S. 33 E S. 19 1/2 W N 5 W S 89 W	20 24 38 1/2 530	
E.								
F.								
G.				R O Wic	30 16	S 7 W N 25 W	140 88	
H.								
I.								
K.								
L.								
M.				Lynn.	10" 8"	N 40 E N. 75 W	3 4	(Buck)
7.	Stone		Square	Honey Locust	6"	N 59 W	47	
1.	Stone							
2.	Stone							
X	Stone							

See Old Record

Section

Township

North, Range

West.

INDEX.	CORNERS.	SIZE.	MARKS.	WITNESSES.	SIZE.	DIRECTION.	DISTANCE.	MARKS.
g	Stone	20 x 10 x 12	+					

History of the Darlington Covered Bridge.

As the land north and west of Darlington became thickly populated there was in need of a bridge over Sugar Creek. Farmers wanted to reach local markets and the grist mill located close by regardless of the weather or high water. This led to the movement to build a covered bridge just west of the old mill. At the present time Samuel Martz, was a member of the Board of County Commissioners, the other two members were Taylor Buffington, and David Long. John Manker and John E. Corbin were the ones that carried the petition for the bridge erection. On the petition were the names of the following: William Cox, Enoch Peacock, William Milner, Jacob Deans, William Griest, Guard Booher, Henry Huffman, Thomas & William Wheeler, John B. Lowman, Zieba Thomas, and many others. These names which figured prominently in the early history of the community. Donation towards the project totalling \$ 1,585. were made by the people of the community and on April 15, 1866 these donations were received by the Board of County Commissioners. The Board then appropriated the additional funds needed, and the present site was selected June 13, 1866. The Board the proceeding March directed that a practical bridge builder be engaged. Ricard Epperson was appointed superintendent of the construction. The contract was awarded to Joseph Kress. The bridge was completed in 1868. Each year several people travel many a mile to view the old mill and bridge. Artist spends hours sitting on the banks of Sugar Creek, making sketches of these landmarks which become more and more romantic with the passing of each year. This is usual too because they are close enough together to be placed on a single canvas. Cora Moore Peele, a former resident of Darlington, now of Whittier California, etched the likeness of the mill on a wooden plaque, and sent it back to her home town to be hung in the Public Library where it may be seen today.

Copied from the Lafayette Courier Journal, April 11, 1942.

By, Karl M. Laurimore, Surveyor of Montgomery County, Ind.

INDEX.	CORNERS.	SIZE.	MARKS.	WITNESSES.	SIZE.	DIRECTION.	DISTANCE.	MARKS.
--------	----------	-------	--------	------------	-------	------------	-----------	--------

NOV. 3, 1978

WHILE SEARCHING FOR SECTION STONES. WE FOUND AND VERIFIED STONE "K" AT THE NW 1/4 1/4 CORNER OF SEC. STONE IS 0.65' BELOW ROAD SURFACE. LATER THAT SAME DAY WE FOUND AND VERIFIED STONE "b" 332.76' WEST OF STONE "K". STONE "b" IS LEVEL WITH ROAD SURFACE.

JULY 1, 1980

MONUMENTED STONES "K" AND "b"

NOTE: MEASUREMENTS ARE TAKEN FROM REFERENCE POINTS SET IN CONCRETE.

SYMBOLS:

⊗ - STEEL RE-BAR 2 FEET LONG WITH A PLASTIC MAGNETIC CAP SET AT GROUND LEVEL.

T - 5 FOOT FENCE POST WITH A TRIANGULAR SIGN BOLTED TO THE TOP OF IT WHICH STATES " SURVEY MARKER - DO NOT DISTURB - FOR INFORMATION CONTACT MONTGOMERY COUNTY SURVEYORS OFFICE. MEASUREMENTS ARE TAKEN FROM THE BOTTOM OF T OF STEEL POST.

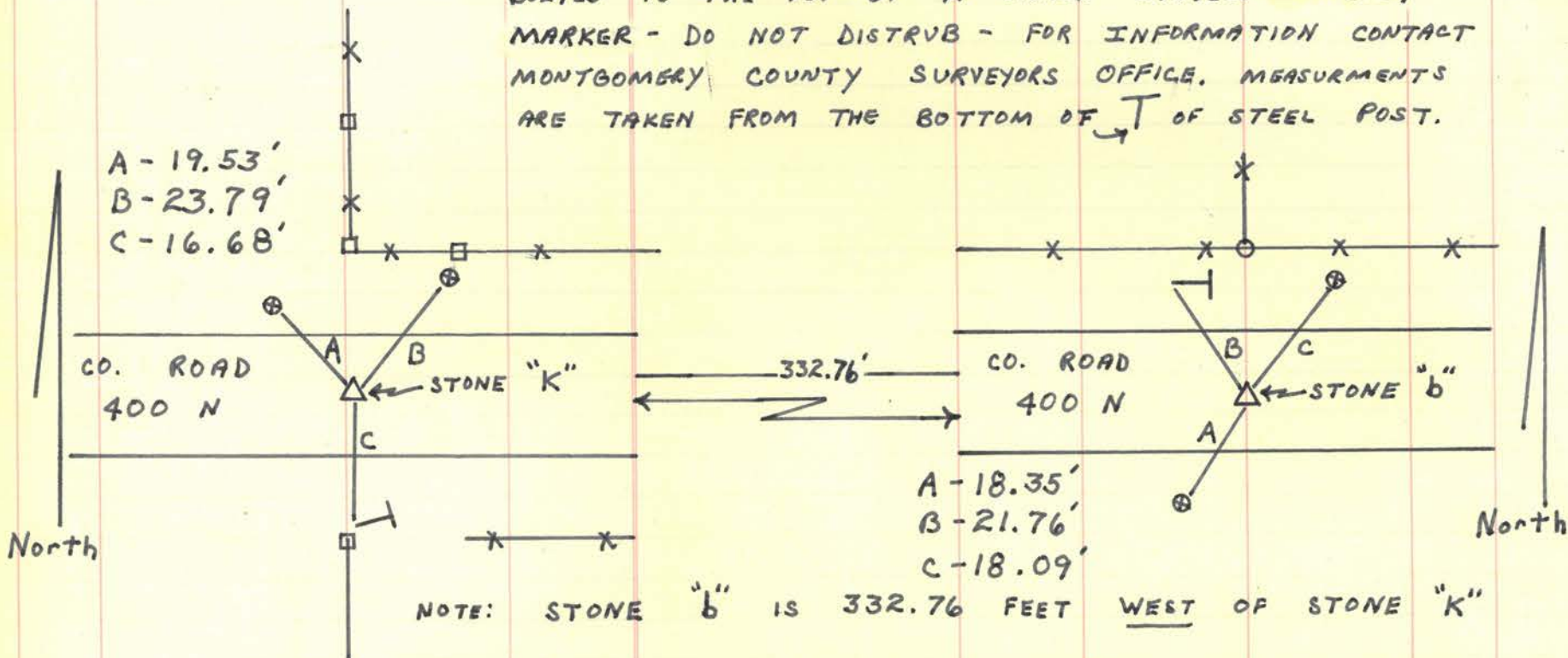

NOTE: STONE "b" IS 332.76 FEET WEST OF STONE "K"

MONUMENTED BY: BRUCE KELLER 1ST DEPUTY M.C.S.
 ALAN IMPICCIHE
 ALAN MELVIN

NOTICE OF SURVEY.

The State of Indiana, }
County of Montgomery, } ss:

To John B. Jordan and Susan E. Jordan

You are hereby notified that on Wednesday June 14, 1916

I will cause a survey to be made of Part of the N.W. Qr. of Sec. Eight (8)
and part of the N.E. Qr. of Sec. Seven (7) in Township Nineteen (19)
North Range Three (3) West, for the purpose
of establishing and perpetuating that part of the East line of said Sec -
tion 7 marking the boundaries of your tract of land and mine

Said survey to be made by the County Surveyor of said County and State, and
that Your Share of the costs of said survey will be taxed against your lands
adjoining said corner or corners.

Signed *W. P. Milner*
Served by *William G. Moore*

Served June 2 1916

Section 8, Township 19 North, Range 3 West.

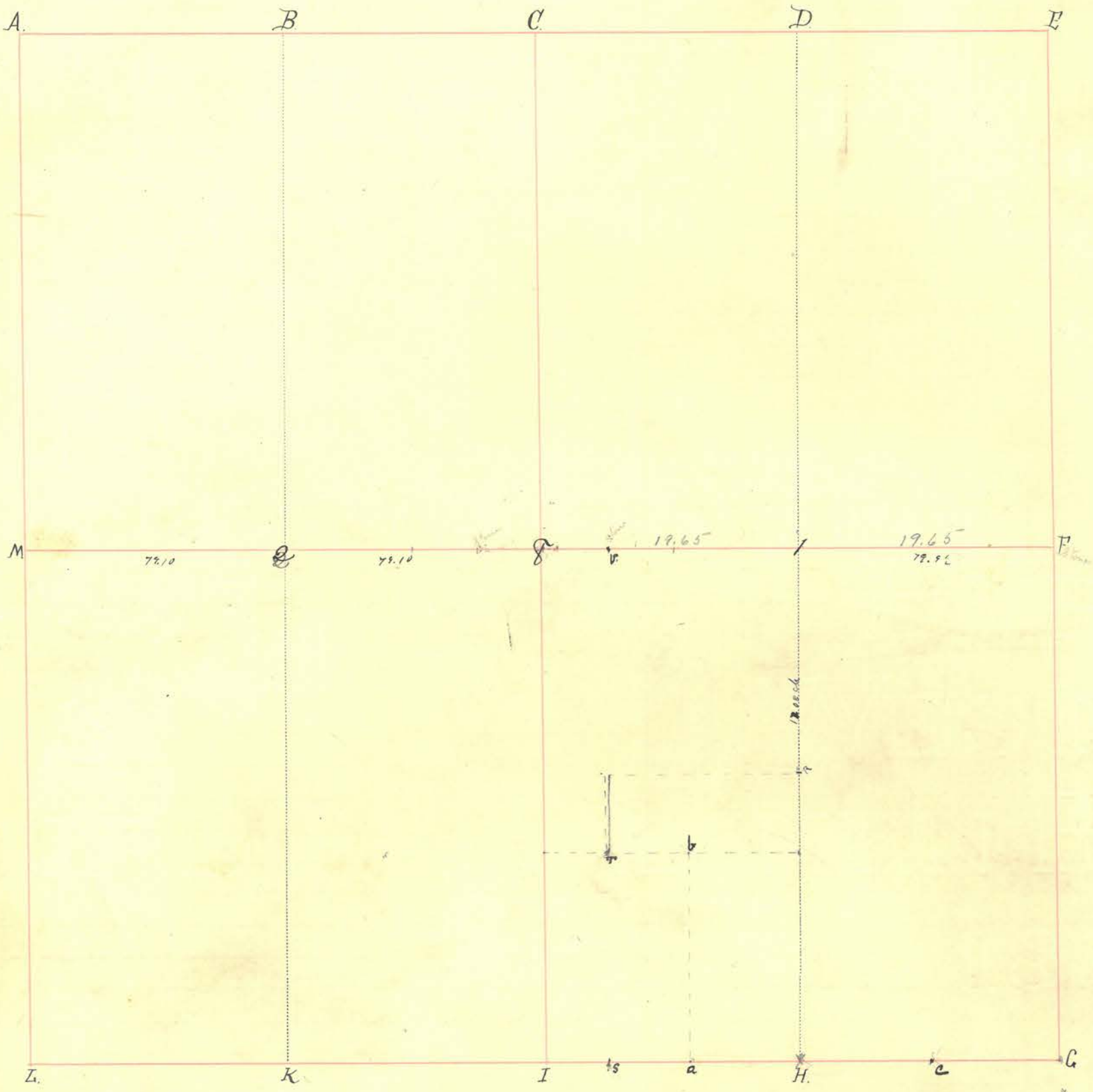

INDEX.	CORNERS.	SIZE.	MARKS.	WITNESSES.	SIZE.	DIRECTION.	DISTANCE.	MARKS.
A.								
B.								
C.	Stone							
D.								
E.	Stone			E to Q = one straight line				
F.	Iron pipe 30" long			original witness				
G.								
H.	Stone							
I.	Stone							
K.								
L.								
M.								
Q.	Stone							
R.	Stone							
S.								
T.								
U.	Stone							
V.								
W.								
X.								
Y.								
Z.	Stone							

INDEX.	CORNERS.	SIZE.	MARKS.	WITNESSES.	SIZE.	DIRECTION.	DISTANCE.	MARKS.
R	Stone							
S	Stone							
T	Stone							
V	Stone							
C	Stone			Iron Fence post	2 1/2"	N 5 W	31	
b	Stake			Stone		West	9.82	
a	Stone			Stone		West	5.00	
				"		East	1.05	
				"		West	4.98	
				"		East	8.53	

Sept 24 1903

Due notice having been given by Hannah M. Peckler "et al" for more than 10 days previous to the date of this survey I established corners at a, b, and c. a to b = 65 rods; a to H. 9.53 chains; C is equidistant between A and H. Corners witnessed as above set forth.
 John Shrum Chain man
 James A. Harding & Co. Surveyor.

Section 9 Township 19 North, Range 3 West.

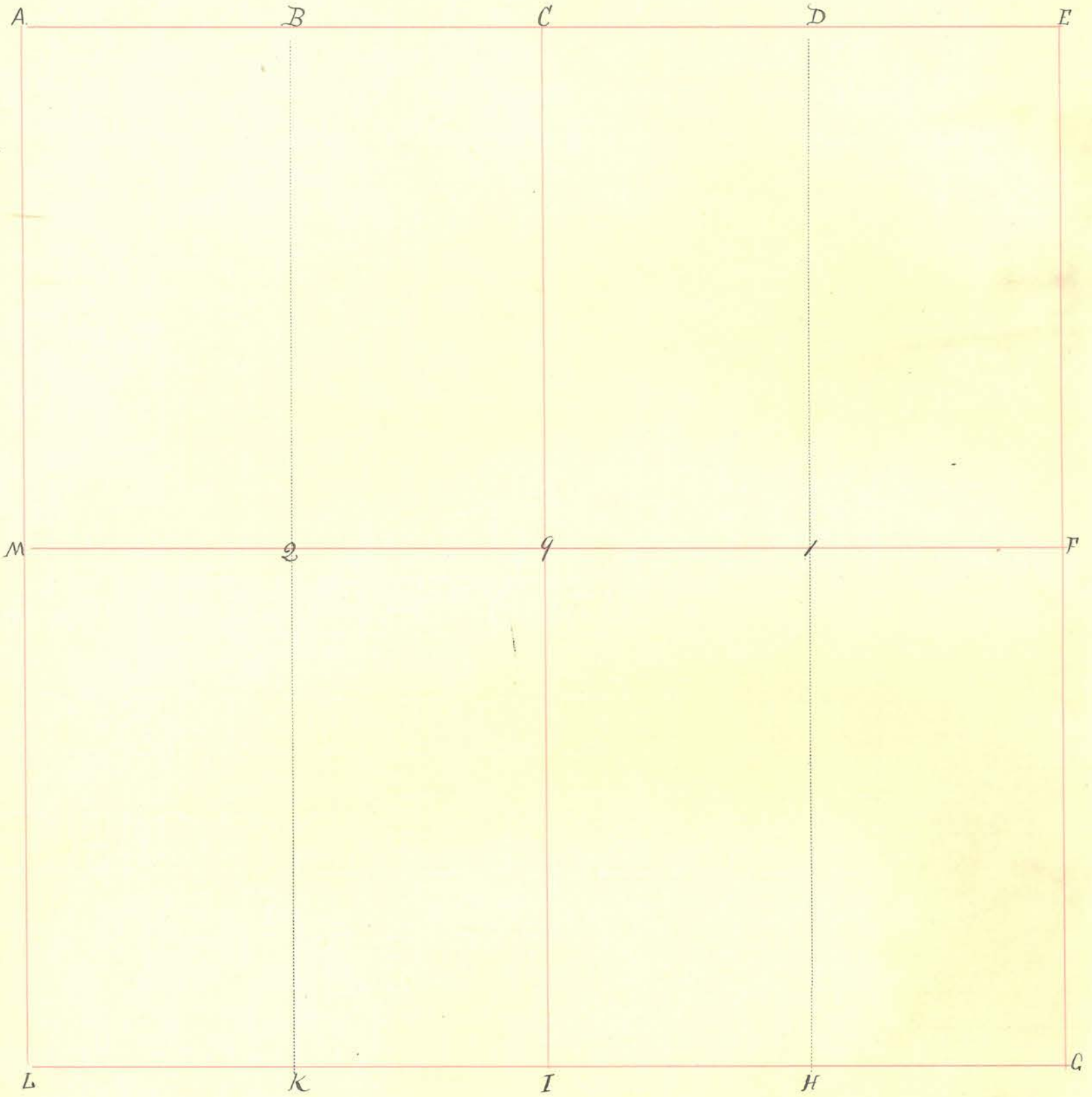

INDEX.	CORNERS.	SIZE.	MARKS.	WITNESSES.	SIZE.	DIRECTION.	DISTANCE.	MARKS.
A.								
B.				Beech, Oak.	12" 4"	cr. 89° W cr. 54° W	121. 88.	
C.								
D.				Cherry, Beech.	26" 18"	S. 73° W cr. 62° E	9 33.	
E.								
F.								
G.								
H.								
I.								
K.	Stone							
L.								
M.	Stone.							
9.				Stake " "	9" 8"	S. 20° W cr. 21° W	3. 12.	
1.								
2.	Stone.			Black Oak Stake.	18" 10"	N 44° W. S. 34 1/2° E.	35. 188	

INDEX. CORNERS. SIZE. MARKS. WITNESSES. SIZE. DIRECTION. DISTANCE. MARKS.

May 13th 1889.
 Surveyed tract: Beg at H. thence N. 2, 30 ch. to stone (Granite) thence W. to
 12.00 chains to stone, (Granite) thence S. 2, 30 ch. to stone (Granite); thence E. 12.00 ch. to stone (Granite)
 3. A.

Due notice given by Wm. Brown Jr.

Mat. Shippin } Surveyor
 Ch. V. Scott } Chainman

A. Stone (Original) with two stones on top.

B. Stone. Set from White Oak (Witness.) bit by stone (S. 11° W. 40)

James W. Wray
 S.M.C. Ind.

a STONE (GRANITE)
 b STONE "
 c STONE "

Section 12. Township 19 North, Range 3 West.

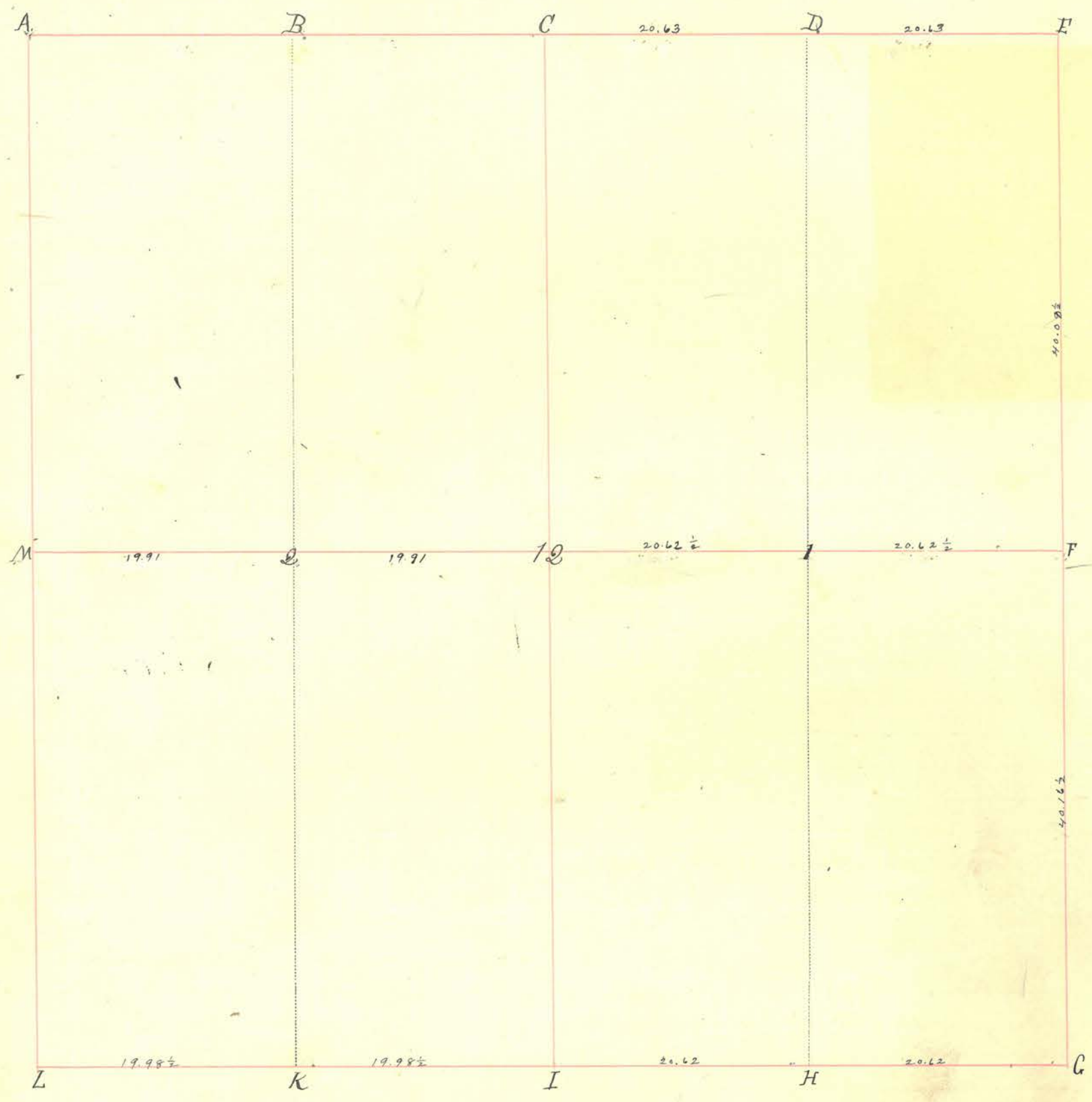

INDEX.	CORNERS.	SIZE.	MARKS.	WITNESSES.	SIZE.	DIRECTION.	DISTANCE.	MARKS.
A.	Stone			Red Oak	18"	S 75 E	17	
B.	Stone			White Oak	30"	S. 15° W	12.	
C.	Stone			Red Oak	24	N 75° W	38	witnessed
D.	Stone. Stone (see note)			Hickory	14"	N. 18° W	12 1/2	8-10-1898
				Oak.	6"	S 15 1/2 E	88.	
E.	Stone							
F.	Stone							
G.	Stone			Stone		North	16 1/2 ft	
H.	Stone			White Oak	20"	N. 12 1/2° W	33 1/2	
				" " " "	30"	N. 8 1/2° W	23.	
I.	Stone	5 1/2 - 38		Kim. Leunmore - G.S.		Center Road.		
				O. Fitzpatrick Asst.				
K.	Stone							
L.	Stone			Black Walnut	14"	N 46 1/2° W	56	
M.	Stone	original		Elm	30"	N. 84° W	28 1/2	
				Ironwood	18"	N. 70° E.	34 1/2	
12.	Stone			Oak.	12"	S. 5 1/2° E	25 1/2	
				Elm.	10"	S. 63° W	37 1/2	
1.				Gray Ash	16"	N. 62 1/2° W	17 1/2	
2.	Stone			Ironwood.	6"	N. 12° W	24 1/2	(Back)

Section Township North, Range West.

INDEX. CORNERS. SIZE. MARKS. WITNESSES. SIZE. DIRECTION. DISTANCE. MARKS.

Notice to Survey.
 The State of Indiana, }
 County of Montgomery, } s s
 Michael Hampton, Newton Bratton, James
 A. Ringer, Edmund Beasley, Calvin Grimes,
 and all others.
 To whom it may concern: You are hereby
 notified that on Monday, August 1st, 1898, I
 will cause a survey to be made of my land in
 section 12, township 19 north, range 8 west,
 for the purpose of establishing and perpetu-
 ating the lines and corners thereof.
 Said survey to be made by the county sur-
 veyor of said county and state. And that
 your share of the costs of said survey will be
 taxed against your lands adjoining said cor-
 ner or corners.
 Signed, CLEAVILLE M. COOK.
 26th

8-1-10-1898 Due notice having been given by C.M. Cook corners
 were located at F, 1, 12, 2, K, I, H & G.

F	Stone	Stone	South	8 feet	} Horizontal Measurement
1	/	Stone Stone	368 3/8 E 141 E	27 1/2 ft 26 feet	
12	Stone	Stone	South	16 1/2 feet	
2	Stone	Stone	North	15 ft 11 in	
G	Stone	Stone	North	16 1/2 ft	
H	Stone	Stone	South	19 ft 7 in	
I	Stone	Stone	South	19 ft 7 in	
K	Stone	Stone	S 48 E	28 1/2 ft	

 H.E. Wagners Survey
 Perry Bowers & Nathan Kutar - Chaimmen

June 19, 1898
 Due Notice having been given By W.P. Binford
 I surveyed the E 1/4 of the North west quarter. Found all corners
 correct as established. also located section corner at A,
 all parties present & consenting. also located corner at
 D for W.P. Medham.
 James A. Harding
 S.M. Co

MAY 4 1938
 FOUNDSTONE AT "G" COUNTY LINE ROAD, REF. BOONE COUNTY BRIDGE
 EAST, INSIDE EDGE OF BOTTOM OF HANDRAIL (CEMENT)

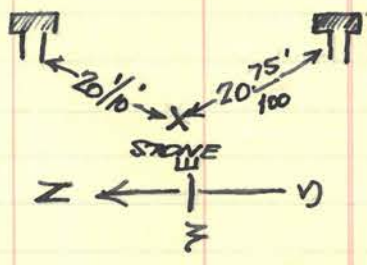

WITNESSES: J.C. GRIMES
 RAY LINN, SUPT OF ROADS, M.C.
 OTTO F. FITZPATRICK.
 Hare M. Lawrence,
 SURVEYOR OF MONTGOMERY CO.

Section 13. Township 19 North, Range 3 West.

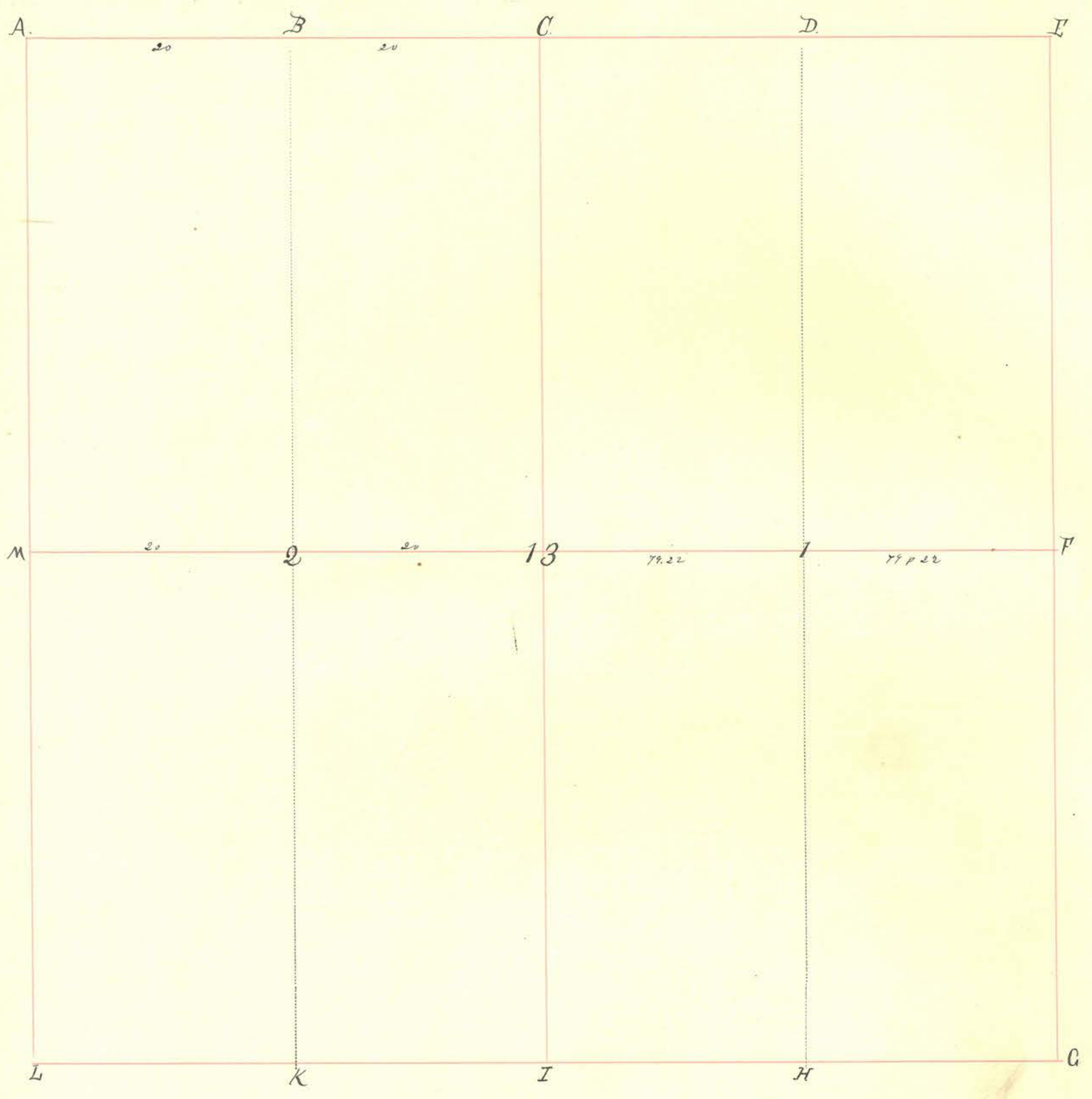

INDEX.	CORNERS.	SIZE.	MARKS.	WITNESSES.	SIZE.	DIRECTION.	DISTANCE.	MARKS.
A.	Stone.							
B.								
C.								
D.								
E.								
F.								
G.								
H.								
I.								
K.								
L.								
M.								
13.								
1.				Asch. Elm. White Oak	5" 20" 48"	Cr. 10 3/4 W N. 70 1/2 E Cr. 59 3/4 W	12 19.	
2.				Black Oak Oak	30" 22"	Cr. 8 1/4 E S. 23 1/2 W	57. 37.	

Section 13 Township 19 North, Range 3 West.

INDEX.	CORNERS.	SIZE.	MARKS.	WITNESSES.	SIZE.	DIRECTION.	DISTANCE.	MARKS.
--------	----------	-------	--------	------------	-------	------------	-----------	--------

March 24th 1858.
 E 1/2 of N.E. qr. and E 1/2 of S.E. qr. for W. Green. N 1/2 of N.E. qr for Nathaniel Booker.
 N 1/2 of S.E. qr for Isaac Decker. E 1/2 of N.W. qr for Geo. Needham. W 1/2 Elisha Francis
 Ketchum

Section 15 Township 19 North, Range 3 West.

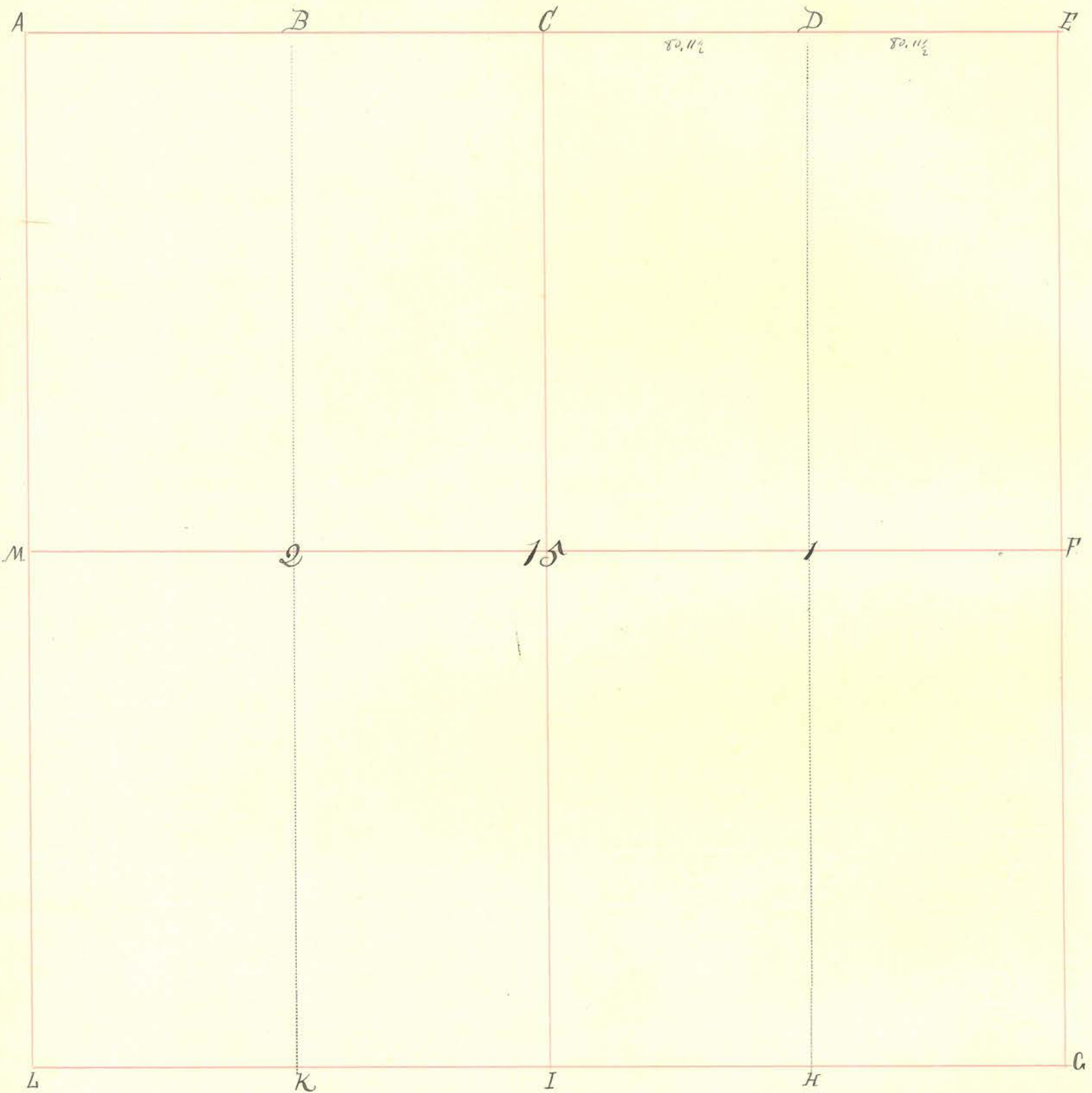

INDEX.	CORNERS.	SIZE.	MARKS.	WITNESSES.	SIZE.	DIRECTION.	DISTANCE.	MARKS.
A.	<i>Stone.</i>							
B.								
C.								
D.								
E.								
F.								
G.								
H.								
I.								
K.								
L.								
M.								
15.								
1.								
2.								

Section 16 Township 19 North, Range 3 West.

INDEX.	CORNERS.	SIZE.	MARKS.	WITNESSES.	SIZE.	DIRECTION.	DISTANCE.	MARKS.
--------	----------	-------	--------	------------	-------	------------	-----------	--------

x
y

Stake

Sugar
White Oak

24"
18"

N. 67 1/2 W
S. 44 1/2 E.

34'
162.

March 2nd 1858.

N 1/2 of Sec. 16 also N 1/2 of S.E. qr for James Cunningham, S 1/2 of S.E. qr for William Buckhannon. S.W. qr for Thomas Lackey.

June 16th 1859.

Due notice having been given by Elizabeth Conner to William Butcher, the following course was established. D. K. L. M. 2. 16.

Section

Township

North, Range

West.

INDEX.	CORNERS.	SIZE.	MARKS.	WITNESSES.	SIZE.	DIRECTION.	DISTANCE.	MARKS.
NOV. 3, 1978	FOUND STONE "b" 332.76 FEET WEST OF STONE "B" FOR MONUMENTATION SEE JULY 1, 1980. SECTION 7 TOWNSHIP 19 N. RANGE 3 WEST							

Section 19 Township 19 North, Range 3 West.

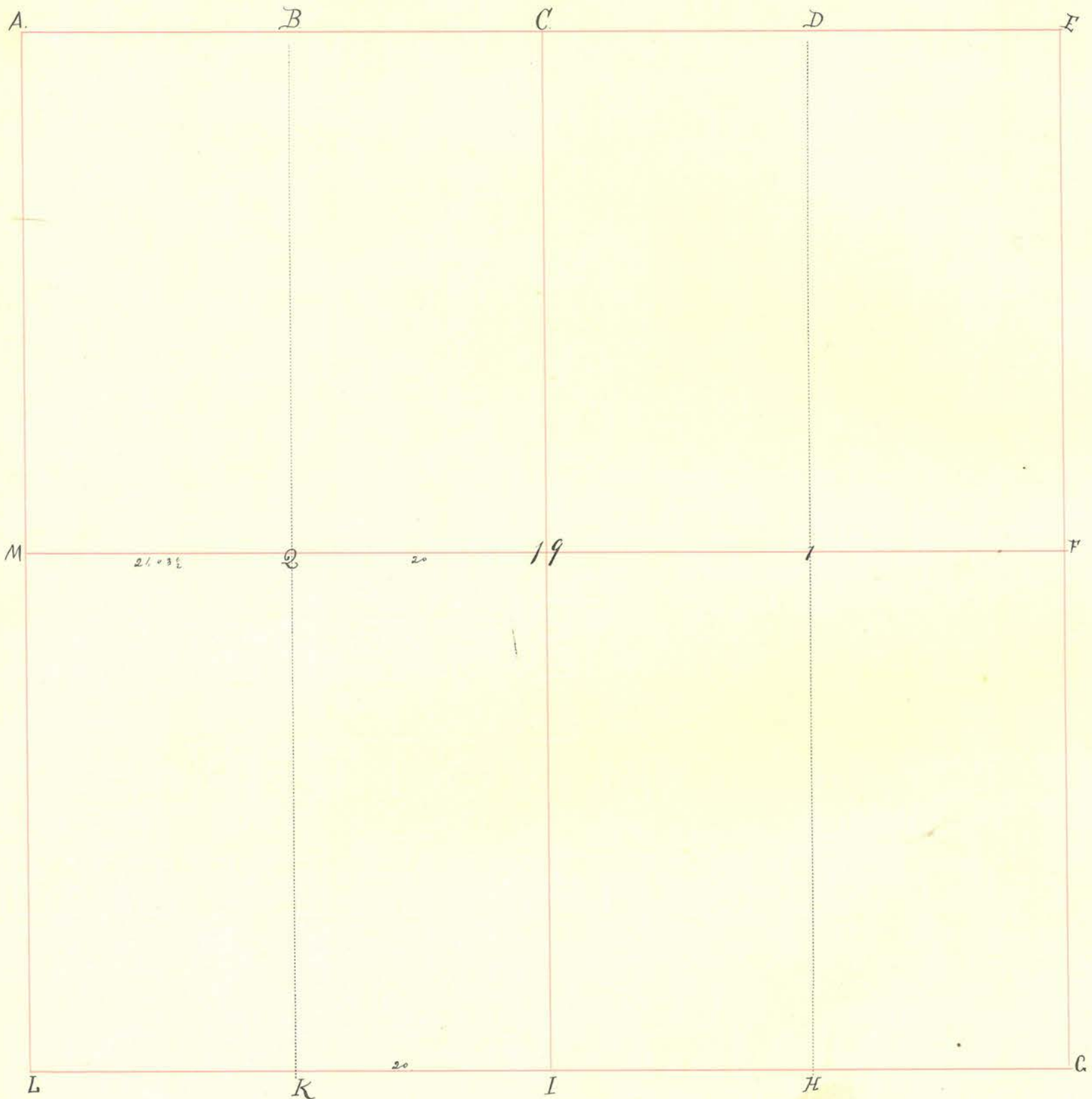

INDEX.	CORNERS.	SIZE.	MARKS.	WITNESSES.	SIZE.	DIRECTION.	DISTANCE.	MARKS.
A.				Sugar	3 1/2"	South	8.	
B.				Hickory.	2"	N 80° W.	13.	
C.								
D.								
E.								
F.								
G.								
H.	Stone.							
I.								
K.				Hickory	20"	N 33° W	20	
L.				White Oak.	18"	N 34° E	40 1/2	
M.				Beech	18"	N 80° E	6 1/2	
19.				" "	14"	N 27 1/2° E	26.	
1.	Stone.			Poplar	30"	N 10° W	10 1/2	
2.				" "	36"	N 40° E.	35.	
				White Oak	40"	S. 63° E	14-	
				" " "	22"	S. 83 1/2° E	20 1/2-	

Ketchum C.S.

Section. 30. Township 19. North, Range 3. West.

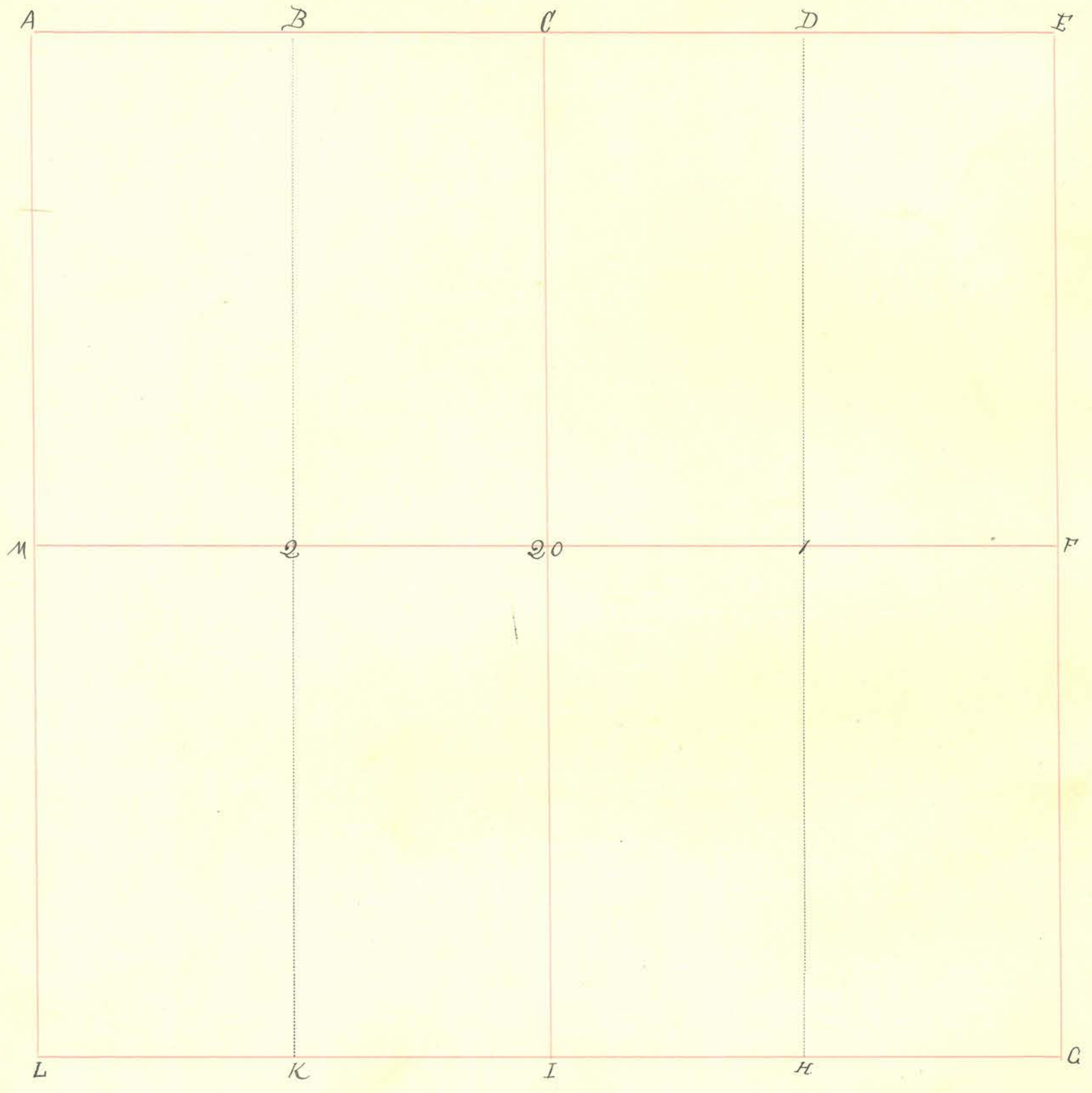

INDEX.	CORNERS.	SIZE.	MARKS.	WITNESSES.	SIZE.	DIRECTION.	DISTANCE.	MARKS.
A.								
B.								
C.								
D.								
E.								
F.								
G.								
H.								
I.								
K.								
L.								
M.								
20.	Stone			2 ^{1/2} Red Oak	18" 4"	N 70° W S. 30° E	4 22	(Back)
1.								
2.	Stone.							

Section 22. Township 19. North, Range 3. West.

INDEX.	CORNERS.	SIZE.	MARKS.	WITNESSES.	SIZE.	DIRECTION.	DISTANCE.	MARKS.
X y				Black Hair Nail Black Walnut	20" 10" 10"	N. 52° E N. 76° W N. 67° E	56 32 27.	
				March 3 rd 1854. The E ^y of S. E. gr. J. Wilcox. February 19 th 1857. N. W. gr. L. W. Buchanan. 40 rods out of the S. E. corner to				
				John A. Stewart.				
								Ketchum Co. See "Old Record."

Section 23 Township 19 North, Range 3 West.

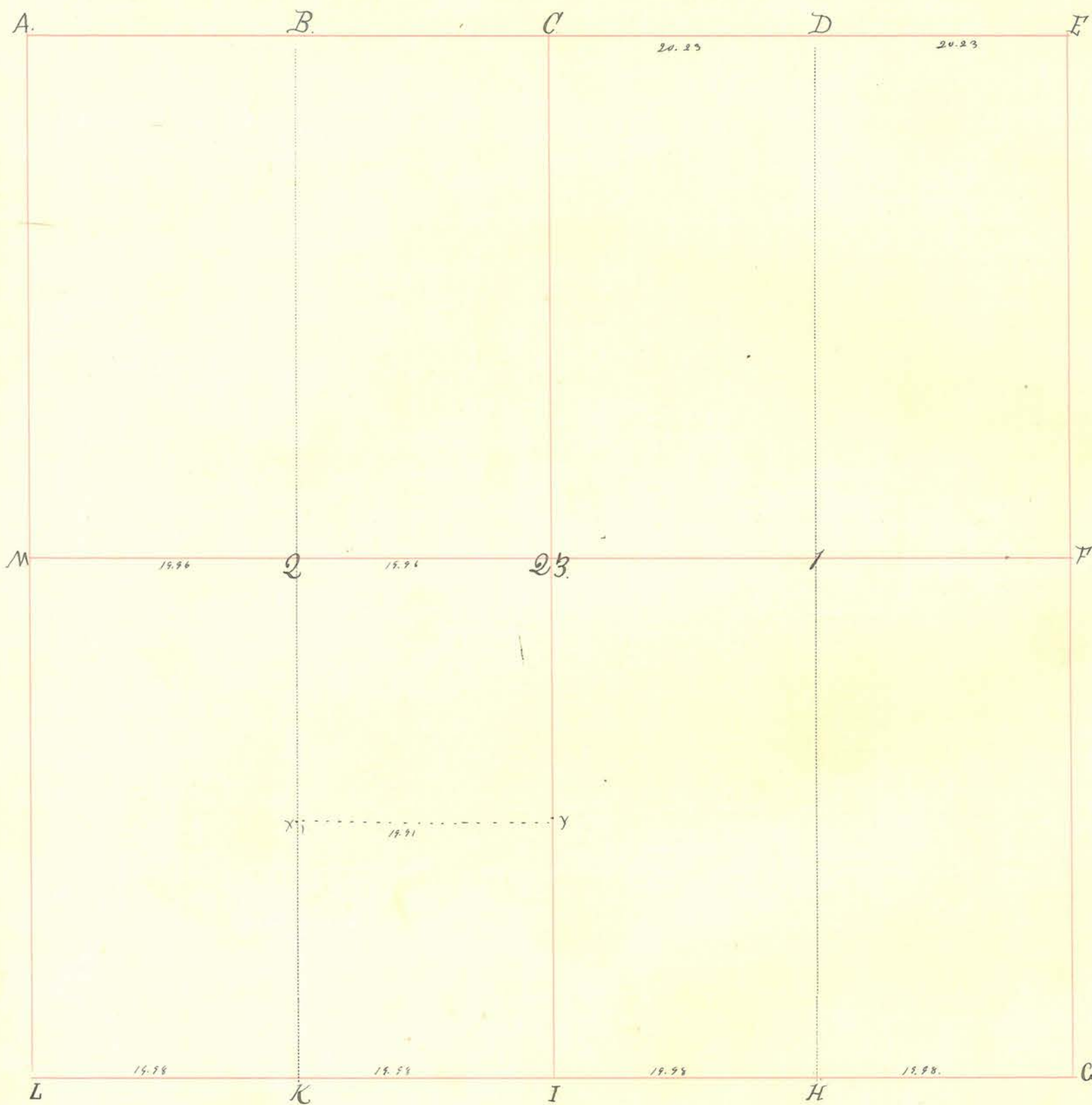

INDEX.	CORNERS.	SIZE.	MARKS.	WITNESSES.	SIZE.	DIRECTION.	DISTANCE.	MARKS.
A.								
B.				Beech.	27"	Cr. 13 1/2° W.	11.	
C.				Red Oak.	16"	S. 12 3/4° W.	47.	
D.				Sugar	18"	S. 53° E.	41 3/4	
E.				White Oak	45"	S. 85° W.	47.	
F.								
G.								
H.				Hickory	24"	Cr. 6° E.	15.	
I.				Ash.	10"	S. 40° E.	30.	
J.								
K.				White Oak	20"	West	1.	
L.				Swamp Oak	13"	Cr. 40° E.	12.	
M.								
23.				Black Spruce	12"	S. 80° W.	12.	
1.				Swamp Oak	10"	Cr. 44° E.	24 1/2	
2.				Black.	4"	S. 64° E.	16.	
				Beech.	16"	N. 15° W.	-	
				Beech.	15"	N. 47 1/2° W.	15.	
				" "	14"	S. 41° E.	30.	

Section 23. Township 19 North, Range 3 West.

INDEX.	CORNERS.	SIZE.	MARKS.	WITNESSES.	SIZE.	DIRECTION.	DISTANCE.	MARKS.
λ				Oak. Gr. Elm.	24" 24"	S. 83° E. S. 14°	6 8 1/2	
y				Black Oak Sugar.	36" 8"	N. 30° W. S. 28° W.	24 24 1/2	{Buck}

Section

Township

North, Range

West.

INDEX.	CORNERS.	SIZE.	MARKS.	WITNESSES.	SIZE.	DIRECTION.	DISTANCE.	MARKS.
a b	stone stone			<p>April 21" 1905. Due notice having been given to the interested parties, I therefore surveyed and set corners of the N. W 1/4 of the S. E. 1/4 - Sec. 24 - T 19 N. R 3 W</p>				<p>Gas. A. Harding - by H. C. McElmer. Deputy Co. Suror.</p>

Section 25 Township 19 North, Range 3 West.

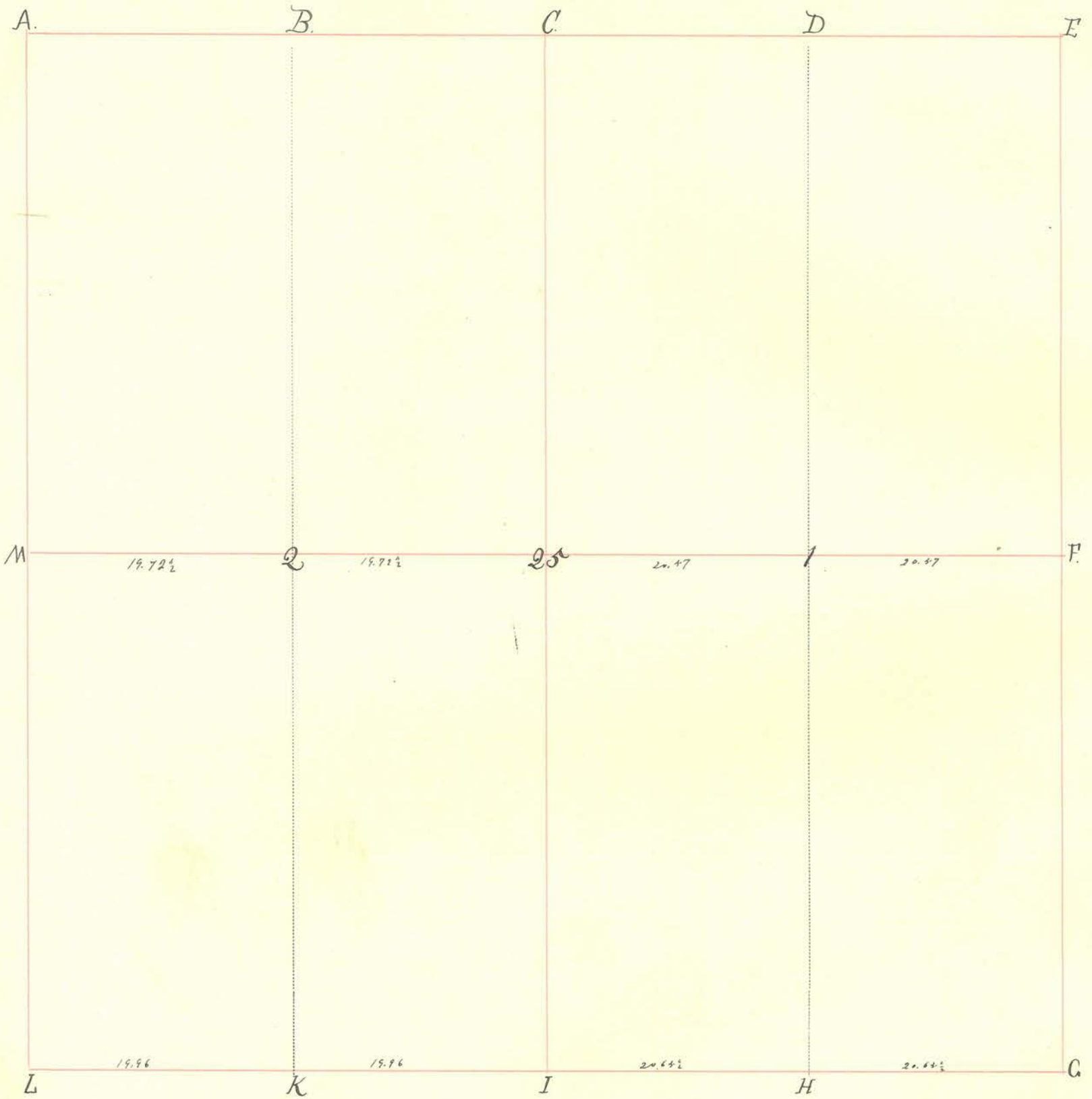

INDEX.	CORNERS.	SIZE.	MARKS.	WITNESSES.	SIZE.	DIRECTION.	DISTANCE.	MARKS.
A.								
B.				White Oak	16"	cr. 83° E.	14.	
C.				Hickory	20"	cr. 20° W.	40.	
D.								
E.								
F.								
G.								
H.				Sugar	9"	S. 70° W.	14.	
I.				Hickory	20"	N. 47° E.	14.	
K.				Black Oak	20"	cr. 60° W.	21.	
L.				Swamp Oak	20"	S. 3° W.	21.	
M.								
25.	Stake.							
1.				Sugar	12"	N. 43° W.	12.	
2.				Oak	9"	S. 30° W.	36.	
				Hickory	10"	S. 41° E.	19.	

Section 26. Township 19 North, Range 3 West.

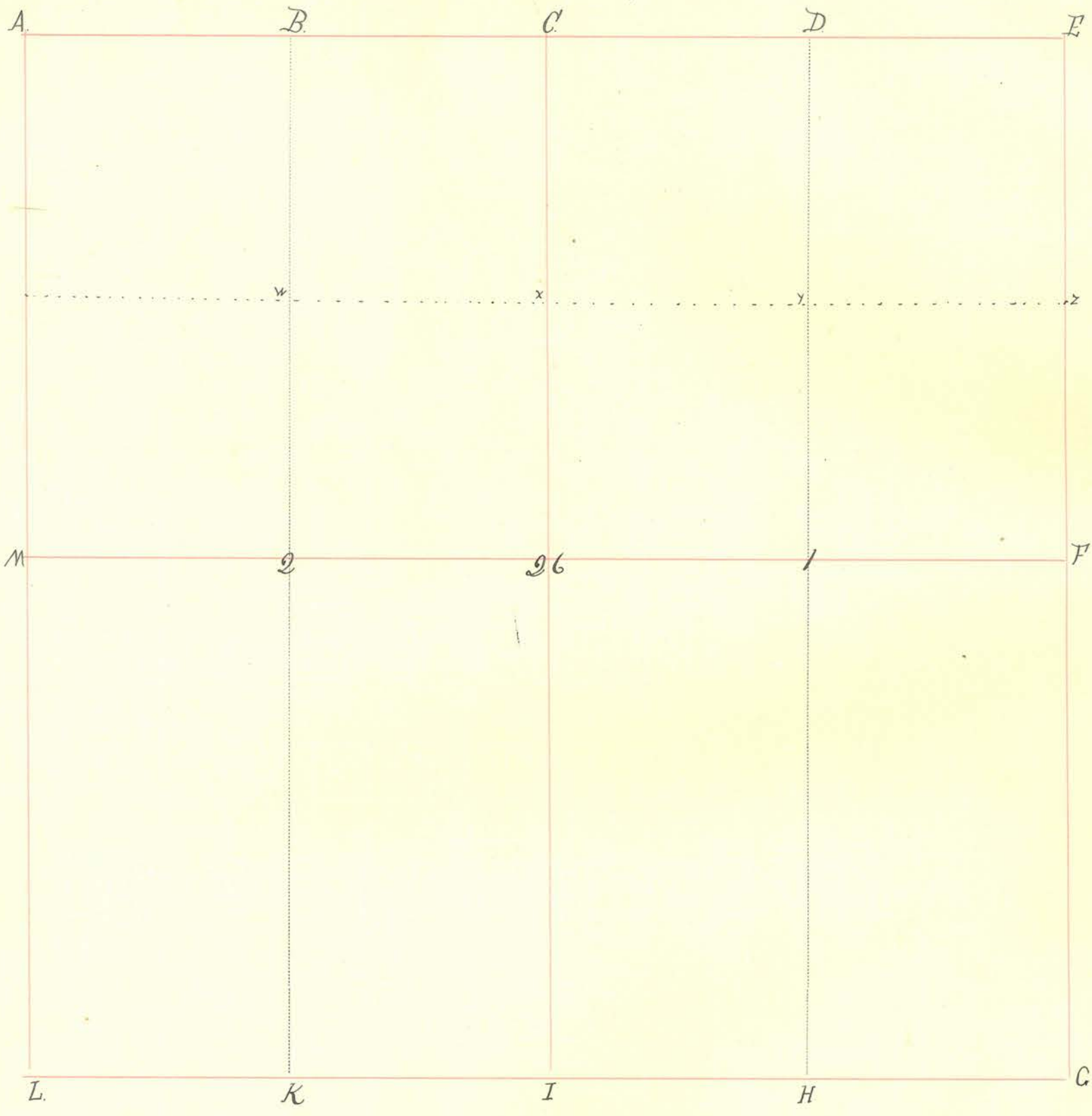

INDEX.	CORNERS.	SIZE.	MARKS.	WITNESSES.	SIZE.	DIRECTION.	DISTANCE.	MARKS.
A.								
B.								
C.								
D.								
E.								
F.								
G.								
H.								
I.								
K.								
L.								
M.								
26.	Stone.							
1.	Stone.							
2.	Stone.							

Section 26 Township 19 North, Range 3 West.

INDEX.	CORNERS.	SIZE.	MARKS.	WITNESSES.	SIZE.	DIRECTION.	DISTANCE.	MARKS.
w.	Stone.							
x.	Stone.							
y.	Stone.							
z.	Stone.							

Section 27 Township 19 North, Range 3 West.

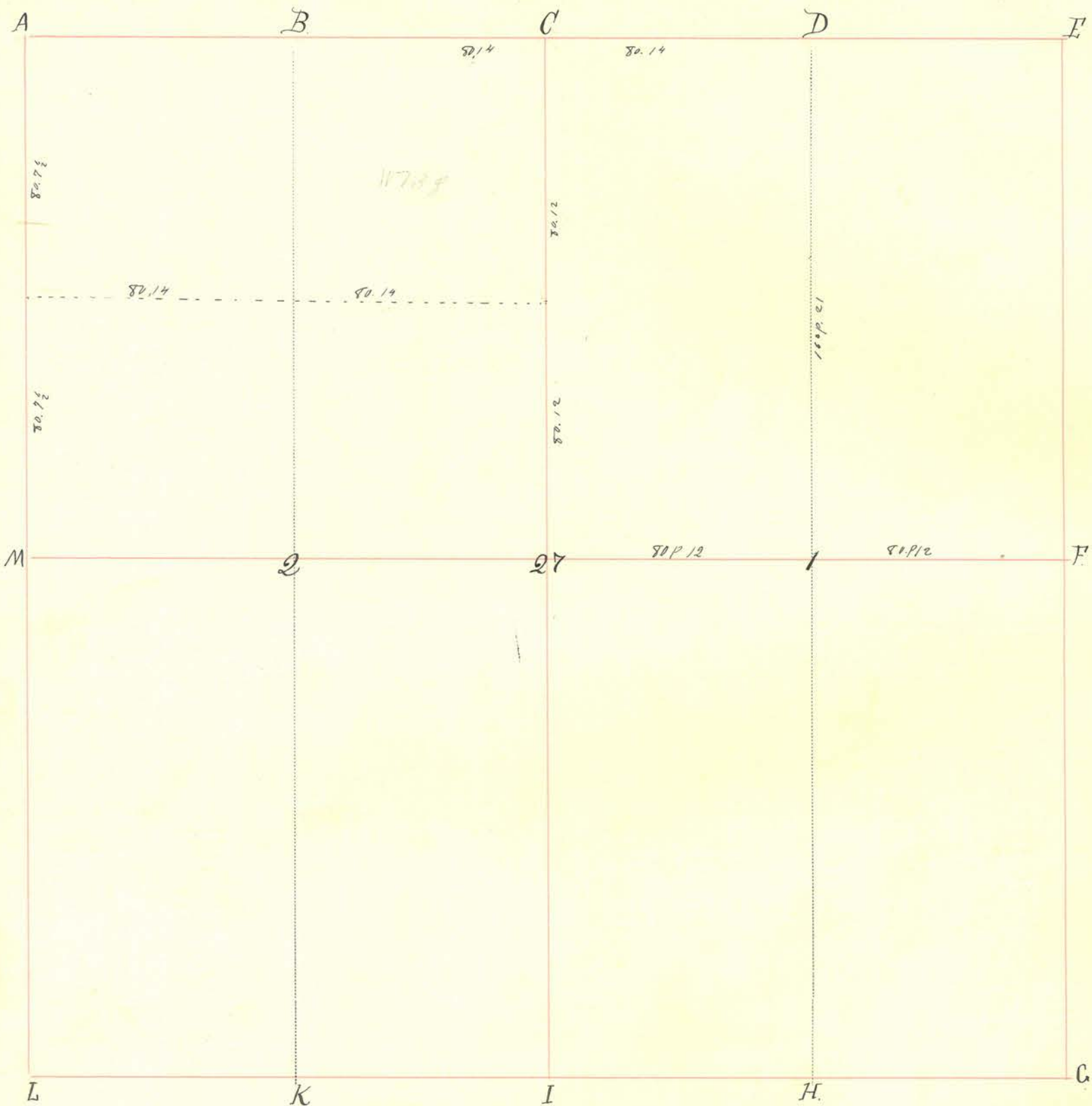

INDEX.	CORNERS.	SIZE.	MARKS.	WITNESSES.	SIZE.	DIRECTION.	DISTANCE.	MARKS.
A.	<i>Stone.</i>							
B.								
C.								
D.								
E.								
F.								
G.								
H.								
I.								
K.								
L.								
M.								
27								
1.								
2.								

Section 28. Township 19 North, Range 3 West.

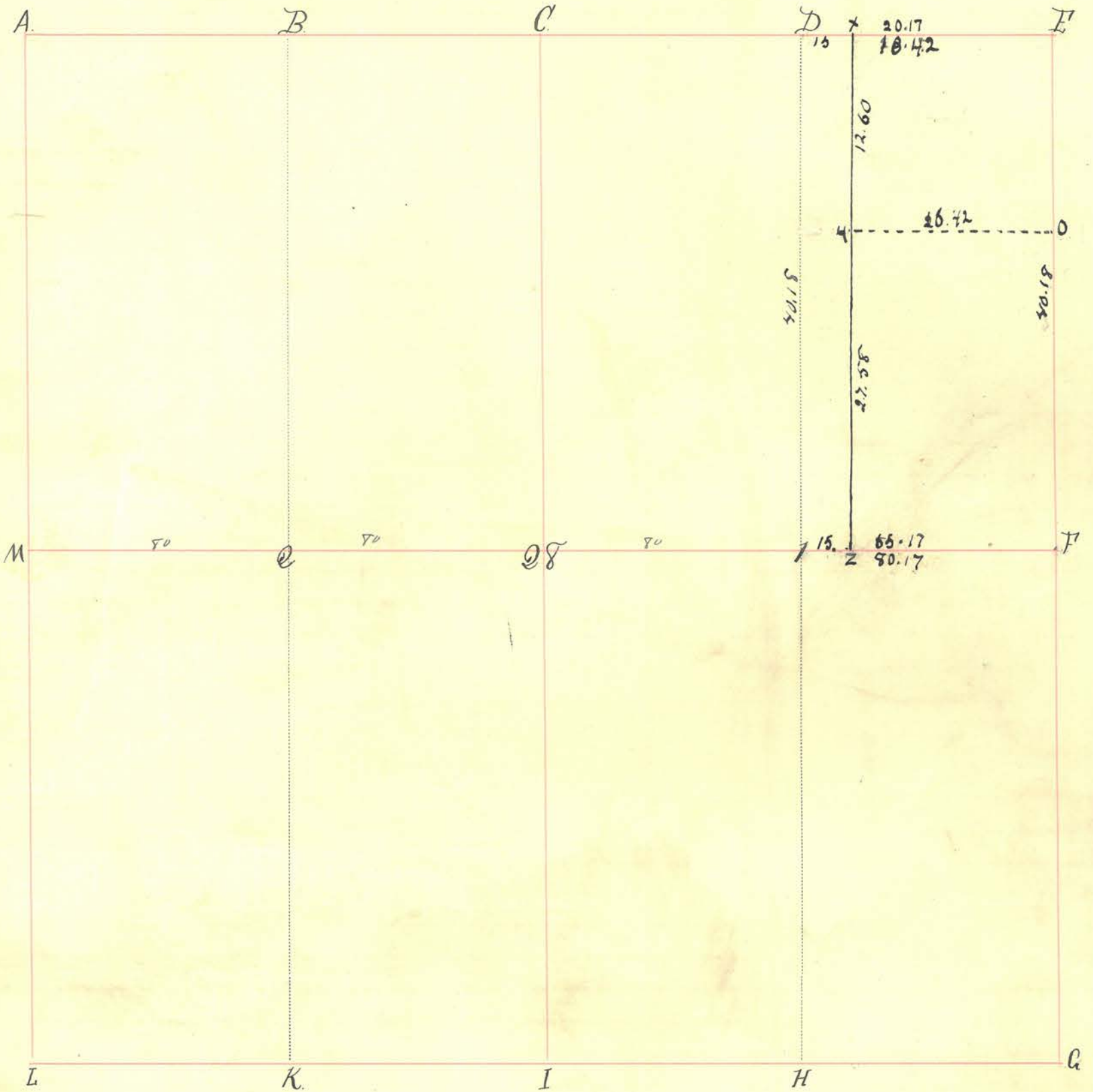

INDEX.	CORNERS.	SIZE.	MARKS.	WITNESSES.	SIZE.	DIRECTION.	DISTANCE.	MARKS.
A.	Stone, Original.							
B.				Hickory White Oak	24"	N. 26° 3/4 E.	48 1/2	
C.					24"	S. 47° 1/2 W.	315 1/2	
D.	Stone							
E.	Stone							
F.	Stone, Original.							
G.								
H.								
I.								
K.								
L.								
M.								
28.				White Oak Sycamore Apple Tree. Plum Bush.	4"	N. 57° W.	81.	
1.				Hickory Red Oak.	3"	S. 46 1/2 E.	43.	
2.					8"	N. 27° W.	47 1/2	
					8"	N. 41 1/2 E.	60.	
					14"	N. 26 1/2 W.		
					6"	N. 83° E.	12.	

Section 28 Township 19 North, Range 3 West.

INDEX.	CORNERS.	SIZE.	MARKS.	WITNESSES.	SIZE.	DIRECTION.	DISTANCE.	MARKS.
--------	----------	-------	--------	------------	-------	------------	-----------	--------

N. W. cor to George Vanderwerker, W 1/2 of N. E. cor to Jas. Paine. E 1/2 of N. E. to Old M. Moore. the S E cor to James McKee. and 50 acres of the north end of the E 1/2 of S. W. cor to Samuel D. K. Dole S. end Henry Haffner. and W 1/2 of said cor. Saml. Hitchen P.S.

- 0 Stone
- x Stone
- y Stone
- z Stone

vide "Old Record"

Section 30. Township 19 North, Range 3 West.

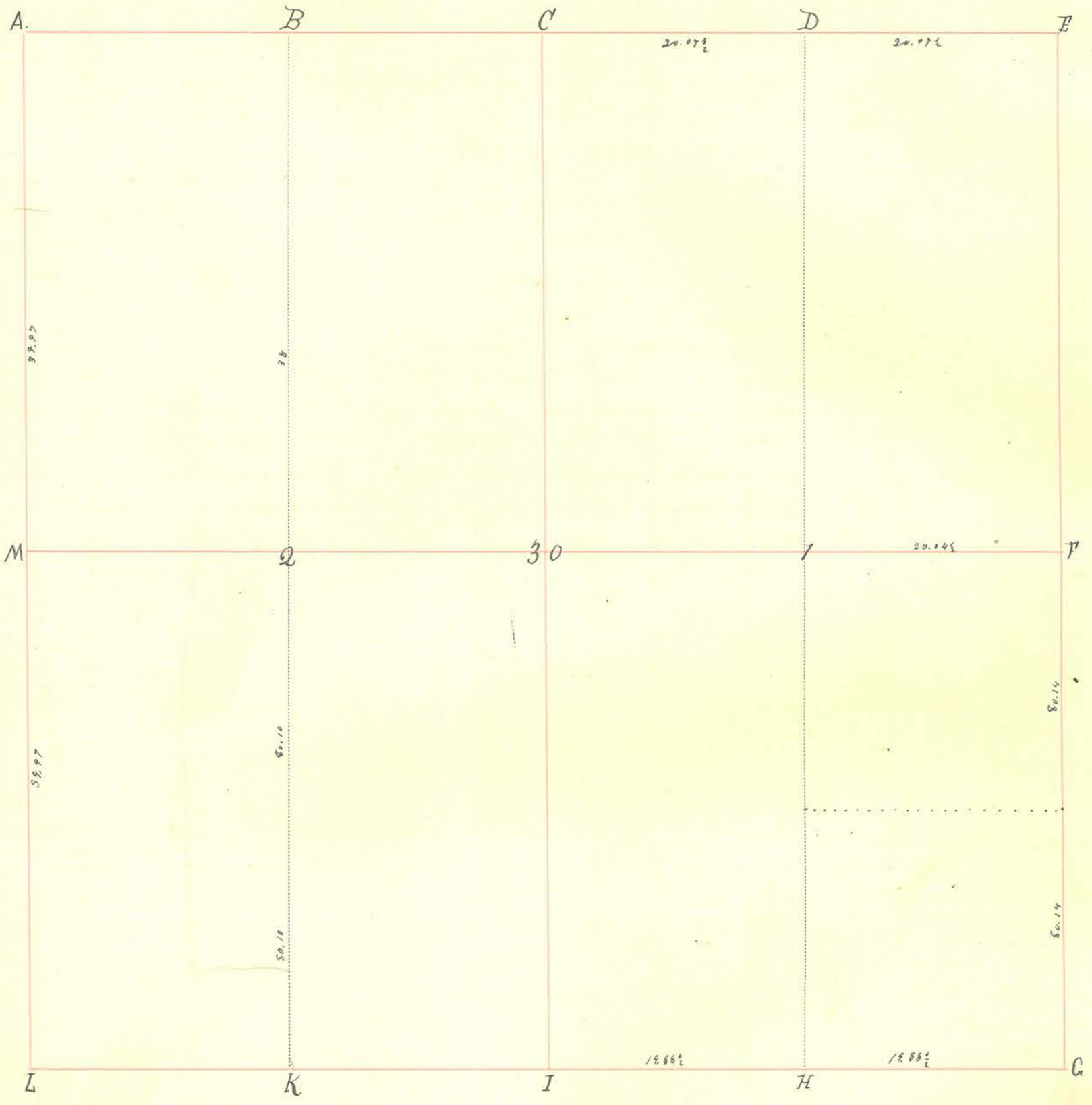

INDEX.	CORNERS.	SIZE.	MARKS.	WITNESSES.	SIZE.	DIRECTION.	DISTANCE.	MARKS.
A.				Black Oak	30"	S. 90° W	47.	
B.				" " "	12"	N. 63° W.	41.	
C.				White Oak	18"	S. 89° E	20.	
D.				Black Oak	12"	S. 86° W	9.	
E.				Hickory	15"	N. 71° E.	12.	
F.				White Oak	20"	S. 11° E.	11.	
G.				" " "	16"	N. 36° E	83.	
H.				Sugar	24"	S. 31° E	8.	
I.				" "	14"	N. 31° W.	7.	
J.				Sugar	12"	S. 88° E.	7.	
K.				" "	15"	N. 14° W.	7.	
L.				White Oak	18"	S. 87° W	14.	
M.				" " "	14"	N. 52° E.	26.	
30.				Elm.	10"	N. 9° E.	14.	
1.				Horseshoe	8"	S. 54° E.	83.	
2.				Cherry	10"	dr. 77° W	18.	
				Red Bud	8"	S. 80° E	24.	
				Black Oak.	10"	N. 43° W	24.	
				Hickory	6"	S. 54° W	12.	
				White Oak	20"	S. 77° W	10.	
				Black Walnut	2"	N. 20° S.	18.	
				Sugar	20"	dr. 27° E	32.	
				White Oak.	28"	S. 21° E	37.	

Stone

Slake & Stone in Field.

(Back)

Section Township North, Range West.

INDEX.	CORNERS.	SIZE.	MARKS.	WITNESSES.	SIZE.	DIRECTION.	DISTANCE.	MARKS.
--------	----------	-------	--------	------------	-------	------------	-----------	--------

MAY 12, 1977
 WHILE SEARCHING FOR SECTION STONES & MARKERS - FOUND
 Stone "I" AT SW COR OF SE 1/4 OF SECTION. Stone
 IS 1.6' BELOW ROAD SURFACE.
 Found By: Russ Nelson - 1st DEPUTY M.C.S.
 LARRY FISHER
 RANDY RIPPY
 SCOT YOUNT

JUNE 28, 1977
 PROCEEDED TO MONUMENT STONE "I"
 NOTE: MONUMENTS ARE STEEL FENCE POSTS SET IN CONCRETE
 WITH A TRIANGULAR SIGN BOLTED TO THE TOP WHICH
 STATES: "SURVEY MARKER - DO NOT DISTURB -
 FOR INFORMATION CONTACT MONTGOMERY COUNTY
 SURVEYORS OFFICE" MEASUREMENTS ARE FROM
 THE BOTTOM OF T OF Steel Posts.

- A- 41.51'
- B- 16.45'
- C- 20.14'

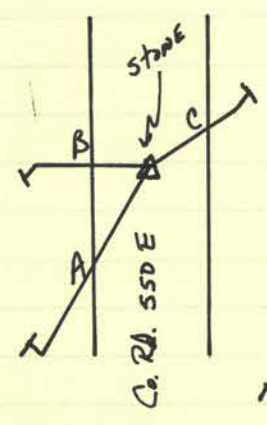

MONUMENTED BY: R. NELSON - 1st DEPUTY M.C.S.
 S. YOUNT

Section 37 Township 18 North, Range 3 West.

INDEX.	CORNERS.	SIZE.	MARKS.	WITNESSES.	SIZE.	DIRECTION.	DISTANCE.	MARKS.
N.	Post. in Road.			Elm	18"	N. 34° E	12.	
O.	"			S. Ash	12"	S. 28° W	19.	
X				Wild Cherry	10"	S. 74° E	11 Lin 36.	} Hunt Dec. 16 th 1891.
Y.				Oak Stump	18"	S. 36° W	44 Lin 36.	
				Oak Stump	2 1/2"	West	37 l.	
				Oak Stump	"	N. 7° E.	32 l.	

E 1/2 of N 1/2 of S.E. 1/4 of Section for Minton Case, and N 1/2 for Samuel S. Lowry.
December 16th 1891.

Interested parties present and consenting, as established 2 and 4,
W. F. Hunt S. M. C. and.

C.	stone			Sugar	20"	N 25 W	5 1/2 ft.
D.	stone			W. Walnut	18"	S 2 W	5 3/4 ft.
E.	stone			stone	6"	"	17 1/2 l.
				"	6" x 8"	E.	25 l.
				Elm	12"	"	37 l.
				W. Walnut	5"	N 89 W	21 l.

State of Indiana }
Montgomery County } ss -

Surveyed pt N. W 1/4 for J. S. Brothers as follows: -
Began at E. located C. and set stone, established line C-a. - distance C-31-
2671 ft. Ran C-A. distance 40, 93 1/2 ch. set stone at E. 10 chains east
of A. Ran the range line A-M-L. set stone at d. 10 chains east of M.
established line d-e. Ran west from F. to M. distance 80.58 chains -
set stone at C. 10 chains west of 31. established line d-c. and c-b. length of
latter. 1122 ft. Interested parties all duly served with notice.
Chairmen Smith, Maswell and James Dale. Rodmen Messrs. Todd and Bryant.
All duly sworn.

Completed August 23, 1900.

Chase Harding Dep. S. M. Co.

approved

MAY 12, 1977

WHILE SEARCHING FOR SECTION STONES + MARKERS - FOUND STONE "C" AT
NW COR OF NE 1/4 OF SECTION. STONE IS 1.6' BELOW ROAD SURFACE

FOUND BY: R. NELSON - 1ST DEPUTY M.C.S.

L. FISHER
R. RIPPY
S. YOUNT

JUNE 28, 1977

PROCEEDED TO MONUMENT STONE "C"
FOR MONUMENT DESCRIPTIONS, LOCATIONS, + MEASUREMENTS SEE 6-28-77
ENTRY FOR STONE "I" OF SEC. 30 T18 R3

MONUMENTED BY: R. NELSON - 1ST DEPUTY M.C.S.
S. YOUNT

Section 32. Township 19. North, Range 3. West.

INDEX.	CORNERS.	SIZE.	MARKS.	WITNESSES.	SIZE.	DIRECTION.	DISTANCE.	MARKS.
x	Stone.			Black Oak.	86"	N. 21° W	22 1/2	
y.	Stone.							(Back)

Section 33. Township 19 North, Range 3 West.

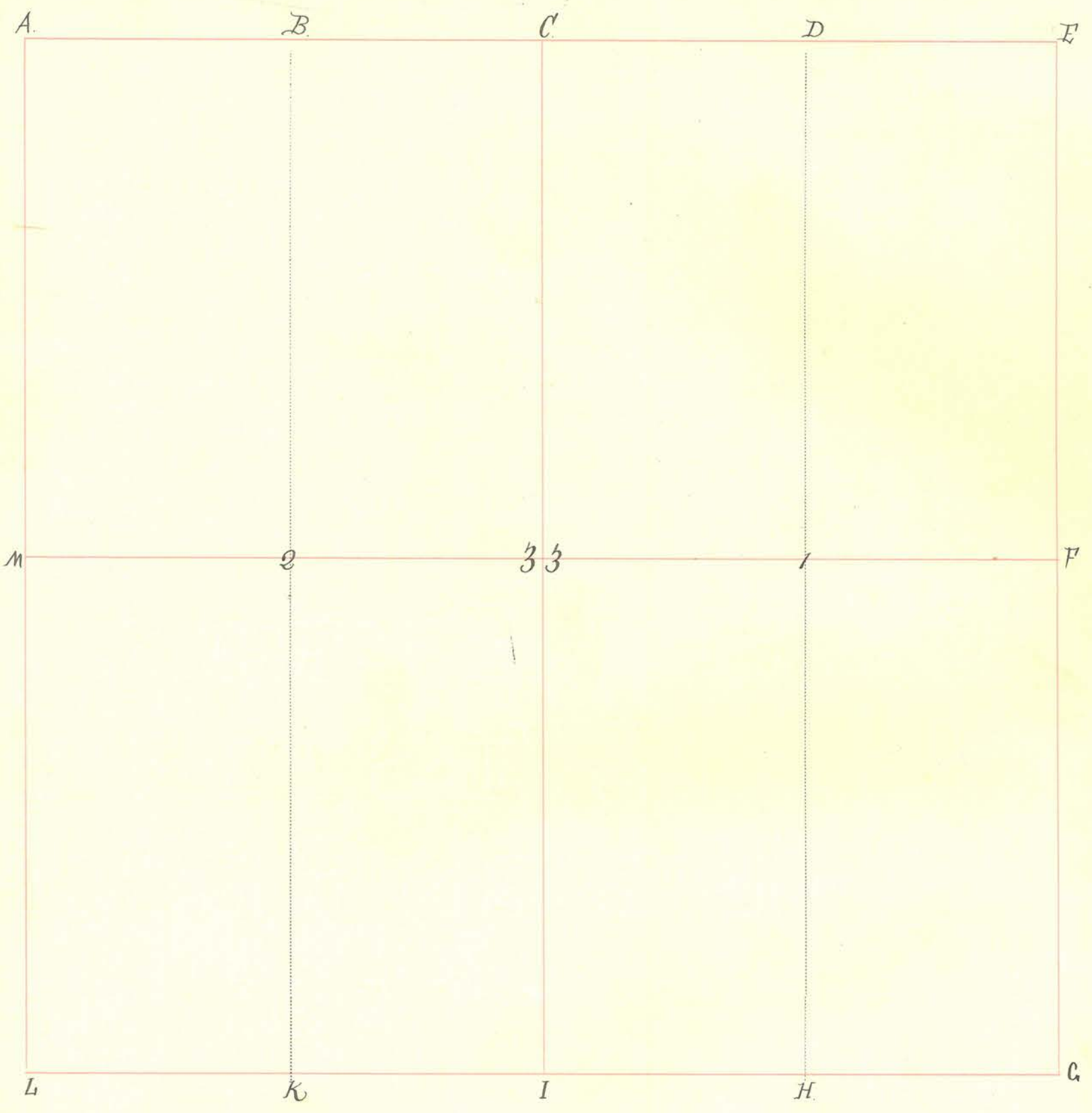

INDEX.	CORNERS.	SIZE.	MARKS.	WITNESSES.	SIZE.	DIRECTION.	DISTANCE.	MARKS.
A.								
B.								
C.								
D.								
E.								
F.								
G.								
H.								
I.								
K.								
L.								
M.								
33.								
1.								
2.								
				White Oaks. Yewer Beech.	20" 4"	N. 49° E. S. 30° W.	33 28.	(Buck)

Section 34. Township 19 North, Range 3 West.

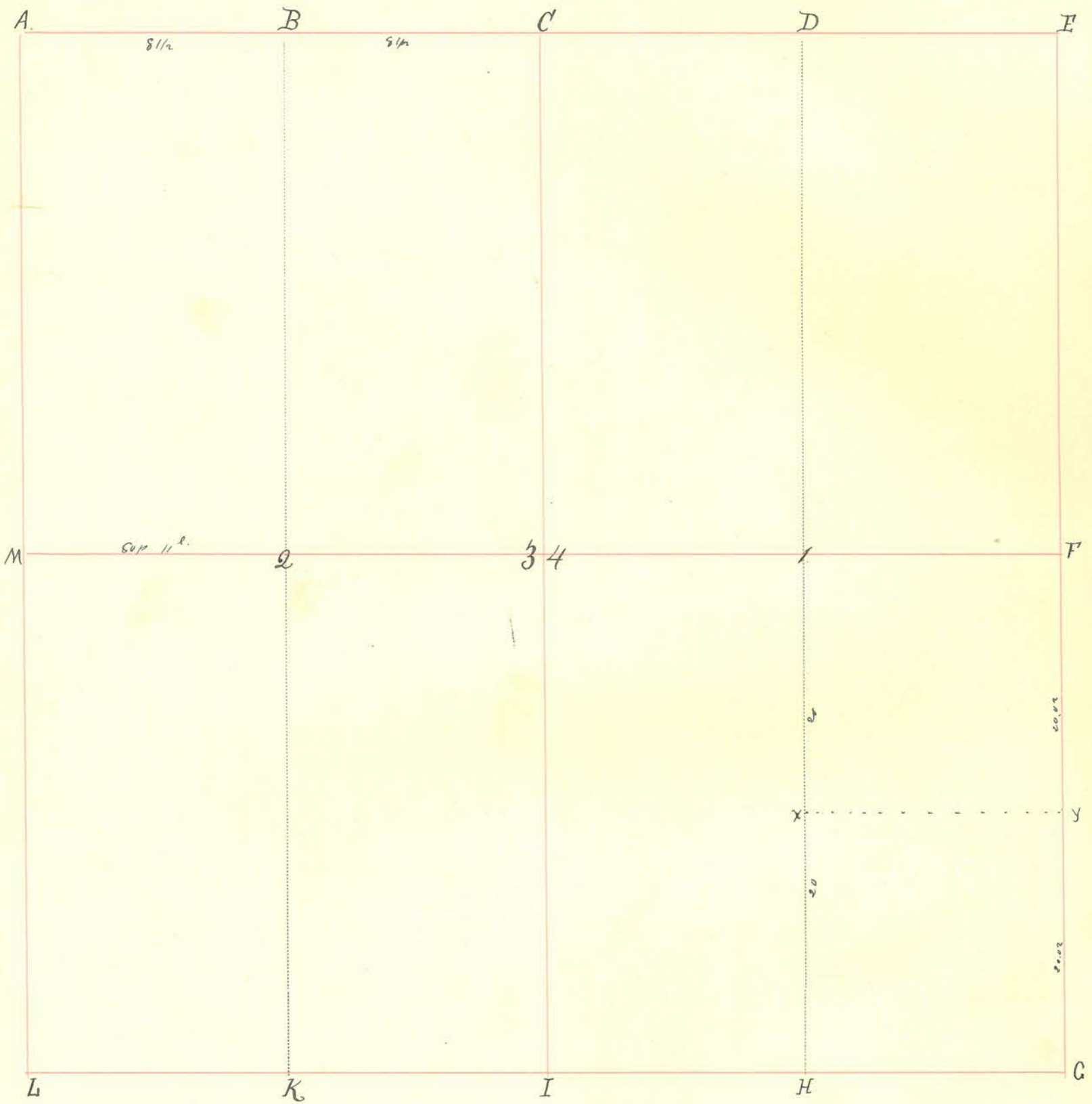

INDEX.	CORNERS.	SIZE.	MARKS.	WITNESSES.	SIZE.	DIRECTION.	DISTANCE.	MARKS.
A.				Hickory Black Oak.	18"	N. 83 1/2° W.	21.	
B.					30"	N. 81° E.	22.	
C.								
D.								
E.								
F.								
G.								
H.								
I.								
K.								
L.								
M.								
34.								
1.				Locust Sugar.	14"	Or. 74° W.	14	
2.					16"	N. 78° E.	39 or 82.	

Section 34 Township 19. North, Range 3. West.

INDEX.	CORNERS.	SIZE.	MARKS.	WITNESSES.	SIZE.	DIRECTION.	DISTANCE.	MARKS.
X y				<i>Beuch</i> <i>" "</i> <i>Beuch</i> <i>" "</i>	30" 26" 24" 16"	S. 52° W N. 87° W N. 62° W East.	32 45. 17 446	
<p><i>May 7th 1833.</i> <i>E 1/2 of S.E. qr divided between Aaron Stewart and Hugh Conig. Conig</i> <i>declined a plat.</i> <i>Oct. 19th 1837.</i> <i>N 1/2 of N.W. qr. to David Sutton.</i> <i>E. Ketchum 1833</i></p>								

Section 35 Township 19 North, Range 3 West.

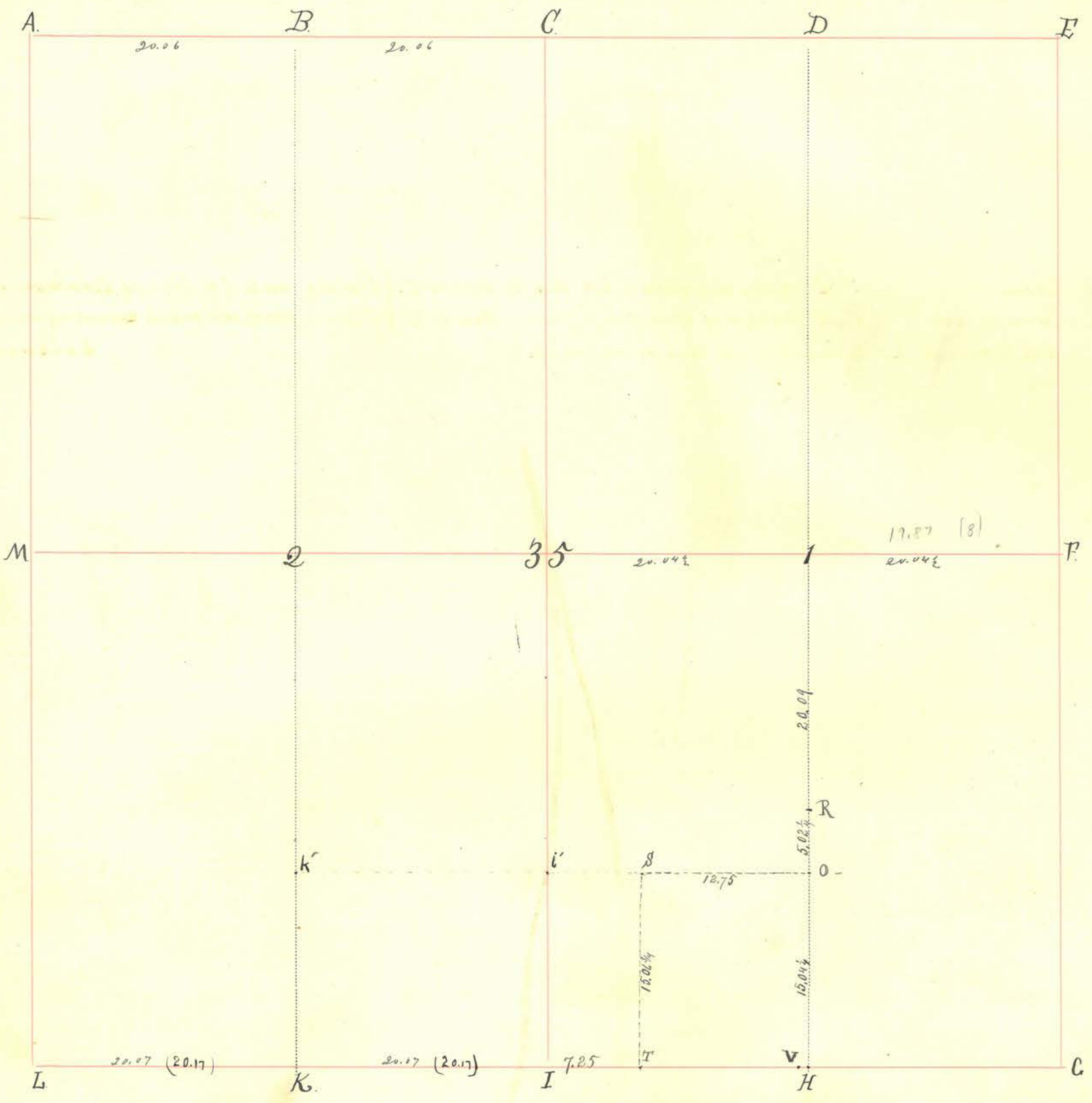

INDEX.	CORNERS.	SIZE.	MARKS.	WITNESSES.	SIZE.	DIRECTION.	DISTANCE.	MARKS.
A.								
B.								
C.				Black Walnut	30"	N. 33° W.	16.	
D.				Sugar.	20"	N. 45° S.	46.	
E.	Stone.							
F.								
G.	Stone in field.							
H.	Stone.							
I.	Stone (set 11/27/05) 40.34 E. of stone @ sw cor. sec., to mark N. & S. center line of sec.							
K.	Stone (set 11/27/05) 20.17 E. of stone @ sw cor. sec. to mark line bet E & W. SW 4.				12"	S. 11° E.	82.	
L.					18"	S. 83° E.	30.	
M.								
35.				Sugar	16"	S. 62° W.	15.	
1.				" "	12"	N. 81° E.	17.	
2.				Sugar	18"	N. 48° E.	14.	
				Buck.	14"	S. 21° E.	21.	
				Hickory	14"	S. 14° E.	14.	
				Buck.	10"	N. 35° E.	37.	

Chile Old Record (Buck)

Section Township North, Range West.

INDEX.	CORNERS.	SIZE.	MARKS.	WITNESSES.	SIZE.	DIRECTION.	DISTANCE.	MARKS.	
H	Stone (Re-set)	4" x 4"		Stone	4" x 4"	W.	10-	-	
O	Stone (Re-set)	4" x 6"		Stone	4" x 4"	W.	20-	-	
R	Stone (Old)	Pointed.							
S	Stone (Re-set)	6" x 6"		Forked Walnut	18"	N. 10° E.	.30	-	
T	Stone	4" x 4"		Stone	2" x 4"	N.	.50	-	
V	Stone (17 1/2 ft. W. of NW. cor. 8 th NE 1/4 R-15-3)								
i.	Stone	1" x 6" - 7.25 S. W. of stone @ S, + 15. N. of stone @ I.							} Survey made for Henry Bowman and Grant McDowell, 11/22/05, both present, consenting, aiding & approving. D.L. Shrum, D.L.S.
k.	Stone (Pointed)	8" x 12" 20.25 W. of stone @ i. + 15. N. of stone @ K.							
	Also, stones @ I + K set to mark lines as indicated,								

D.L. Shrum
Dep. C.S.
11/5/1905

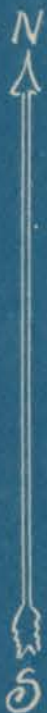

409 chains

18.85 chains
567 acres
13.85 chains

280

N 39° E
6.86 chains
R. 043 acres

N 33° E
7.96 chains

2854

Creek
362 ch.

14.50 chains

4.030 acres

10.36 chains
13.86 chains

3.617 acres

11.36 chains

6.774 acres

15.80 chains

N 68 1/2° E

This corner wid by
by Cor. cement wings of bridge
539 1/4 W 35'
582 1/2 W 35'

Creek

S 82° W
1.32

557.85 W
2.62 ch.

341 ch
558° 45' W

6.97 chains

SURVEY MADE IN
SEC 35 T19N R3W.

March, 1909

Milton L. Nees Surveyor Mont Co.

SEC 35
T19N
R3W

